

BOULDER PONDS SECOND ADDITION

PRELIMINARY DRAFT
PRINTED 3/2/2016

KNOW ALL PERSONS BY THESE PRESENTS: OP4 Boulder Ponds, LLC, a Minnesota limited liability company, fee owner of the following described property situated in the County of Washington, State of Minnesota, to wit:

Outlot H, BOULDER PONDS, Washington County, Minnesota.

Has caused the same to be surveyed and platted as BOULDER PONDS SECOND ADDITION and does hereby dedicate to the public for public use the public ways and drainage and utility easements created by this plat.

In witness whereof said OP4 Boulder Ponds, LLC, a Minnesota limited liability company, has caused these presents to be signed by Ben Schmidt, Vice President this _____ day of _____, 20____.

OP4 BOULDER PONDS, LLC

Ben Schmidt, Vice President

STATE OF MINNESOTA

COUNTY OF _____
This instrument was acknowledged before me on this _____ day of _____, 20____, by Ben Schmidt, Vice President of OP4 Boulder Ponds, LLC, a Minnesota limited liability company, on behalf of the company.

Notary Public, _____ County, Minnesota
My Commission Expires _____

I, Jason E. Rud do hereby certify that I have surveyed and platted or directly supervised the survey and platting of the property described on this plat as BOULDER PONDS SECOND ADDITION; that I am a duly Licensed Land Surveyor in the State of Minnesota; that this plat is a correct representation of the boundary survey; that all mathematical data and labels are correctly designated on the plat; that all monuments depicted on the plat have been or will be correctly set within one year as indicated on the plat; that all water boundaries and wet lands as defined in MS Section 505.01, Subd. 3 existing as of the date of this certification are shown and labeled on the plat; and that all public ways are shown and labeled on the plat.

Dated this _____ day of _____, 20____.

Jason E. Rud, Licensed Land Surveyor
Minnesota License No. 41578

STATE OF MINNESOTA

COUNTY OF _____
The foregoing Surveyor's Certificate was acknowledged before me on this _____ day of _____, 20____, by Jason E. Rud, Licensed Land Surveyor, Minnesota License No. 41578.

Notary Public, _____ County, Minnesota
My Commission Expires _____

LAKE ELMO PLANNING COMMISSION
Approved by the Planning Commission of the City of Lake Elmo, Minnesota, this _____ day of _____, 20____.

PLANNING COMMISSION, CITY OF LAKE ELMO, MINNESOTA
By _____ Chairman
By _____ Secretary

CITY OF LAKE ELMO, MINNESOTA
The foregoing plat of BOULDER PONDS SECOND ADDITION was approved by the City Council of Lake Elmo, Minnesota, this _____ day of _____, 20____, and hereby certifies compliance with all requirements as set forth in Minnesota Statutes, Section 505.03, Subdivision 2.

CITY OF LAKE ELMO, MINNESOTA
By _____ Mayor
By _____ Clerk

COUNTY SURVEYOR
Pursuant to Chapter 820, Laws of Minnesota, 1971, and in accordance with Minnesota Statutes, Section 505.021, Subd. 11, this plat has been reviewed and approved this _____ day of _____, 20____.

By _____ Washington County Surveyor
By _____

COUNTY AUDITOR/TREASURER
Pursuant to Minnesota Statutes, Section 505.021, Subd. 9, taxes payable in the year 20____ on the land hereinbefore described have been paid. Also pursuant to Minnesota Statutes, Section 272.12, there are no delinquent taxes and transfer has been entered on this _____ day of _____, 20____.

By _____ Washington County Auditor/Treasurer
By _____ Deputy

COUNTY RECORDER
Document Number _____
I hereby certify that this instrument was recorded in the Office of the County Recorder for record on this _____ day of _____, 20____, at _____ o'clock _____, M., and was duly recorded in Washington County Records.

By _____ Washington County Recorder
By _____ Deputy

EASEMENT DETAIL

(NOT TO SCALE)

DRAINAGE AND UTILITY EASEMENTS ARE SHOWN THUS:

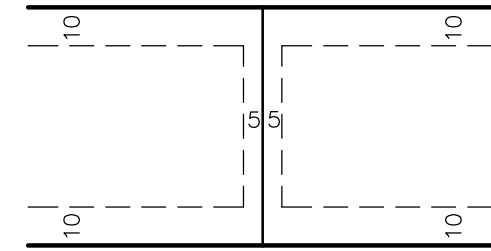

BEING 10 FEET IN WIDTH, AND ADJOINING ALL FRONT AND REAR LOT LINES AND BEING 5 FEET IN WIDTH, AND ADJOINING ALL SIDE LOT LINES, UNLESS OTHERWISE SHOWN ON THIS PLAT.

- DENOTES 1/2 INCH BY 14 INCH IRON PIPE TO BE SET AND MARKED BY RLS NO. 41578.
 - DENOTES FOUND IRON MONUMENT AS LABELED
- ORIENTATION OF THIS BEARING SYSTEM IS BASED ON THE WASHINGTON COUNTY COORDINATE SYSTEM. (NAD 83)

