

*Our Mission is to Provide Quality Public
Services in a Fiscally Responsible Manner
While Preserving the City's Open Space
Character*



NOTICE OF MEETING

**City Council Workshop
3800 Laverne Avenue North
July 11, 2017
6:30 PM**

AGENDA

- | | |
|--|----------------|
| I. Call to Order | 6:30 PM |
| II. CSAH 17 Phase 3 | 6:30 PM |
| III. Bee Safe City Resolution Discussion | 7:00 PM |
| IV. Air B&B | 7:30 PM |
| V. No Parking Ordinance Update | 8:00 PM |
| VI. InWood Water Tower Logo on Both Sides | 8:30 PM |
| VII. Items for Future Work Session Agenda | 8:45 PM |
| VIII. Adjourn | 8:45 PM |



Building a Better World
for All of Us®

MEMORANDUM

TO: Kevin Peterson
FROM: Kristin Petersen
DATE: 7/3/2017
RE: Summary of Adjacent Property Owners Meeting: June 27, 2017

This memo documents summary information regarding the targeted meeting held for adjacent property owners on June 27, 2017 regarding the Lake Elmo Ave Improvement Project (Phase 3).

Basic Meeting Information

- Targeted meeting for the 48 properties directly adjacent to the corridor
- Date: June 27, 2017
- Time: 4:00 – 6:00 pm
- Location: Christ Lutheran Church (11194 36th St N, Lake Elmo, MN 55042)

Meeting Notifications

- Invitation postcards were mailed directly to the 48 properties adjacent to the corridor

Attendance

- Attendance: Approximately 23 individuals signed in
 - See Attachments for digital scans of the sign-in sheets
- 8 staff present
 - 4 Washington County
 - 1 Lake Elmo City Engineer
 - 3 SEH

Meeting Description

The open house meeting did not have a formal presentation, but attendees were encouraged to review presentation boards about the project and ask questions one-on-one. Attendees were also asked to place a small yellow dot on their properties for a visual record of which properties were represented at the meeting.

The presentation boards provided information on project goals, location, schedule, crash data, related studies, existing typical sections, typical sections for 3 alternatives, regional and city trails, and frequently asked questions. Comment cards were also distributed and collected.

Engineers | Architects | Planners | Scientists

Short Elliott Hendrickson Inc., 3535 Vadnais Center Drive, St. Paul, MN 55110-5196
SEH is 100% employee-owned | sehinc.com | 651.490.2000 | 800.325.2055 | 888.908.8166 fax

Comments:

Comments were received in variety of methods, including written comment cards collected at the meeting, verbal comments captured by staff on comment cards, and comments that were emailed. Twenty comments were documented on comment cards by attendees during the meeting. One additional verbal comment was documented by staff. Two comments were submitted by email. See appendix for scanned originals of all submitted comments. The following is a summary of the general themes of the comments:

- 11 comments concerning speed limit and safety, desire to lower speed limit
- 10 comments opposed to sidewalks
- 3 comments supportive of sidewalks
- 5 comments opposing curb and gutter
- 3 comments regarding limited hours/restricted parking
- 4 comments about property impacts and potential assessments

Photos of Event:

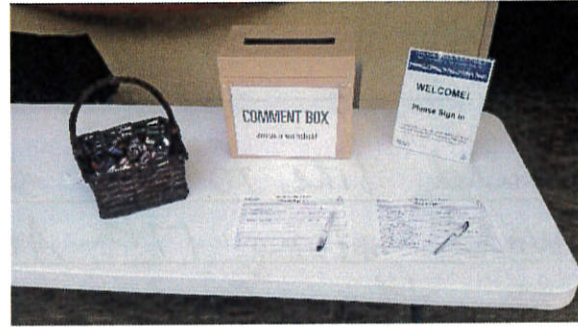
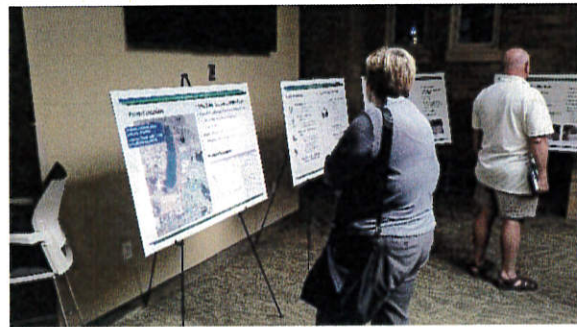
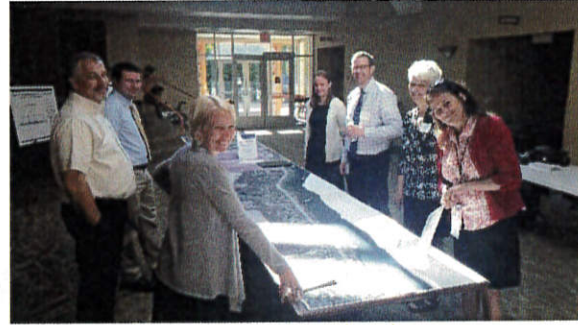
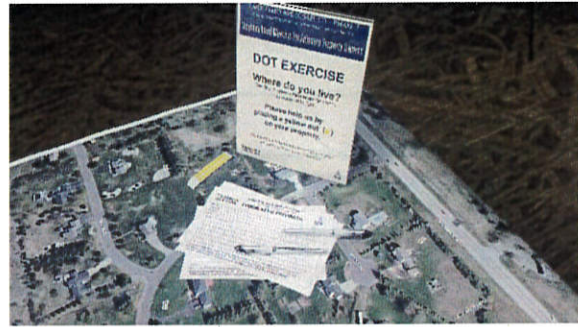

Attachments:

Sign in Sheets
Comment Cards



Lake Elmo Ave (CSAH 17) - Phase 3

From 30th Street N. to 10th Street N. (Co Rd 10)

COMMENTS & FEEDBACK



NAME* _____

ADDRESS* _____

PHONE* _____

EMAIL* _____

**Contact information is optional*

Please do not build a sidewalk along the route, it is a great expense for not a lot of benefit.

Please leave your feedback in the comment box this evening. Comments may also be directed to Kevin Peterson, Washington County Project Manager, at Kevin.Peterson@co.washington.mn.us or by phone at (651) 430-4330. Your feedback will be shared with project staff and included in the project record. Find more information and sign up for email updates at the project website: www.co.washington.mn.us/LakeElmoPhase3



Lake Elmo Ave (CSAH 17) - Phase 3

From 30th Street N. to 10th Street N. (Co Rd 10)

COMMENTS & FEEDBACK



NAME* _____

ADDRESS* _____

PHONE* _____

EMAIL* _____

**Contact information is optional*

*I would like to see some type of walk-way or sidewalk along 17th Ave. I would like to see it on the East-side of the Avenue.
I would also like to see the speed limit reduced!! Thanks!*

Please leave your feedback in the comment box this evening. Comments may also be directed to Kevin Peterson, Washington County Project Manager, at Kevin.Peterson@co.washington.mn.us or by phone at (651) 430-4330. Your feedback will be shared with project staff and included in the project record. Find more information and sign up for email updates at the project website: www.co.washington.mn.us/LakeElmoPhase3



Lake Elmo Ave (CSAH 17) - Phase 3

From 30th Street N. to 10th Street N. (Co Rd 10)

COMMENTS & FEEDBACK



NAME* _____

ADDRESS* _____

PHONE* _____

EMAIL* _____

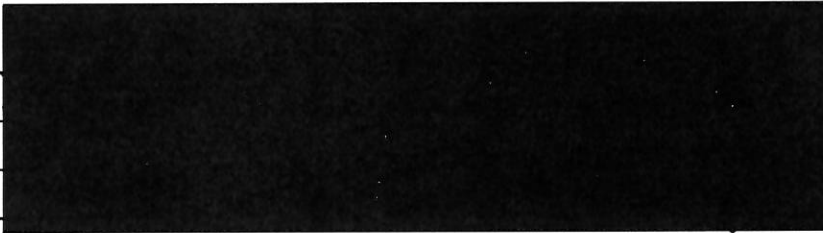

**Contact information is optional*

- Interesting

- Would want to know more about sidewalk

- Most concern:

- 1) speed w/ increasing population
- 2) Run-off
- 3) City Sewer??

Please leave your feedback in the comment box this evening. Comments may also be directed to Kevin Peterson, Washington County Project Manager, at Kevin.Peterson@co.washington.mn.us or by phone at (651) 430-4330. Your feedback will be shared with project staff and included in the project record. Find more information and sign up for email updates at the project website: www.co.washington.mn.us/LakeElmoPhase3



Lake Elmo Ave (CSAH 17) - Phase 3

From 30th Street N. to 10th Street N. (Co Rd 10)

COMMENTS & FEEDBACK



NAME* _____

ADDRESS* _____

PHONE* _____

EMAIL* _____



**Contact information is optional*

I like that there is "no parking" along Lake Elmo Ave
 Sidewalk or path on East side of road would
 be nice for bikers & joggers/walkers.

Curb along property lines would be great!
 I want the "curb & gutter" as in proposal-2

Please leave your feedback in the comment box this evening. Comments may also be directed to Kevin Peterson, Washington County Project Manager, at Kevin.Peterson@co.washington.mn.us or by phone at (651) 430-4330. Your feedback will be shared with project staff and included in the project record. Find more information and sign up for email updates at the project website: www.co.washington.mn.us/LakeElmoPhase3



Lake Elmo Ave (CSAH 17) - Phase 3

From 30th Street N. to 10th Street N. (Co Rd 10)

COMMENTS & FEEDBACK



NAME* _____

ADDRESS* _____

PHONE* _____

EMAIL* _____

**Contact information is optional*

*My preference would be to NOT have a sidewalk put in
I would like to see the pavement resurfaced & possible
gutter + curbs - but please do NOT narrow the road.
The speed limit needs desperately to be reviewed
& lowered*

Please leave your feedback in the comment box this evening. Comments may also be directed to Kevin Peterson, Washington County Project Manager, at Kevin.Peterson@co.washington.mn.us or by phone at (651) 430-4330. Your feedback will be shared with project staff and included in the project record. Find more information and sign up for email updates at the project website: www.co.washington.mn.us/LakeElmoPhase3



Lake Elmo Ave (CSAH 17) - Phase 3

From 30th Street N. to 10th Street N. (Co Rd 10)

COMMENTS & FEEDBACK



NAME* _____

ADDRESS* _____

PHONE* _____

EMAIL* _____

**Contact information is optional*

*Too many seeders
Safety is #1*

STAFF

Please leave your feedback in the comment box this evening. Comments may also be directed to Kevin Peterson, Washington County Project Manager, at Kevin.Peterson@co.washington.mn.us or by phone at (651) 430-4330. Your feedback will be shared with project staff and included in the project record. Find more information and sign up for email updates at the project website: www.co.washington.mn.us/LakeElmoPhase3



Lake Elmo Ave (CSAH 17) - Phase 3

From 30th Street N. to 10th Street N. (Co Rd 10)

COMMENTS & FEEDBACK



NAME* _____

ADDRESS* _____

PHONE* _____

EMAIL* _____

**Contact information is optional*

Concerns about crashes at 30th St.
Consider all-way stop at 30th

Please leave your feedback in the comment box this evening. Comments may also be directed to Kevin Peterson, Washington County Project Manager, at Kevin.Peterson@co.washington.mn.us or by phone at (651) 430-4330. Your feedback will be shared with project staff and included in the project record. Find more information and sign up for email updates at the project website: www.co.washington.mn.us/LakeElmoPhase3



Lake Elmo Ave (CSAH 17) - Phase 3

From 30th Street N. to 10th Street N. (Co Rd 10)

COMMENTS & FEEDBACK



NAME* _____

ADDRESS* _____

PHONE* _____

EMAIL* _____

**Contact information is optional*

LOWER SPEED LIMIT TO 30 MPH
UNTIL 20th ST

Please leave your feedback in the comment box this evening. Comments may also be directed to Kevin Peterson, Washington County Project Manager, at Kevin.Peterson@co.washington.mn.us or by phone at (651) 430-4330. Your feedback will be shared with project staff and included in the project record. Find more information and sign up for email updates at the project website: www.co.washington.mn.us/LakeElmoPhase3



Lake Elmo Ave (CSAH 17) - Phase 3

From 30th Street N. to 10th Street N. (Co Rd 10)

COMMENTS & FEEDBACK



NAME* _____

ADDRESS* _____

PHONE* _____

EMAIL* _____



**Contact information is optional*

VERY POOR PRESTION! People had NO!
ANSWERS!

Please leave your feedback in the comment box this evening. Comments may also be directed to Kevin Peterson, Washington County Project Manager, at Kevin.Peterson@co.washington.mn.us or by phone at (651) 430-4330. Your feedback will be shared with project staff and included in the project record. Find more information and sign up for email updates at the project website: www.co.washington.mn.us/LakeElmoPhase3



Lake Elmo Ave (CSAH 17) - Phase 3

From 30th Street N. to 10th Street N. (Co Rd 10)

COMMENTS & FEEDBACK



NAME* _____

ADDRESS* _____

PHONE* _____

EMAIL* _____



**Contact information is optional*

ALTERNATE 1 IS THE ONLY VIABLE
CHOICE

Please leave your feedback in the comment box this evening. Comments may also be directed to Kevin Peterson, Washington County Project Manager, at Kevin.Peterson@co.washington.mn.us or by phone at (651) 430-4330. Your feedback will be shared with project staff and included in the project record. Find more information and sign up for email updates at the project website: www.co.washington.mn.us/LakeElmoPhase3



Lake Elmo Ave (CSAH 17) - Phase 3

From 30th Street N. to 10th Street N. (Co Rd 10)

COMMENTS & FEEDBACK



NAME* _____

ADDRESS _____

PHONE* _____

EMAIL* _____

**Contact information is optional*

We prefer Alternate #1
the other Alternates would probably impact our
property line and our tree noise barrier

Please leave your feedback in the comment box this evening. Comments may also be directed to Kevin Peterson, Washington County Project Manager, at Kevin.Peterson@co.washington.mn.us or by phone at (651) 430-4330. Your feedback will be shared with project staff and included in the project record. Find more information and sign up for email updates at the project website: www.co.washington.mn.us/LakeElmoPhase3



Lake Elmo Ave (CSAH 17) - Phase 3

From 30th Street N. to 10th Street N. (Co Rd 10)

COMMENTS & FEEDBACK



NAME* _____

ADDRESS _____

PHONE* _____

EMAIL* _____

**Contact information is optional*

no side walk or special assessments.

Please leave your feedback in the comment box this evening. Comments may also be directed to Kevin Peterson, Washington County Project Manager, at Kevin.Peterson@co.washington.mn.us or by phone at (651) 430-4330. Your feedback will be shared with project staff and included in the project record. Find more information and sign up for email updates at the project website: www.co.washington.mn.us/LakeElmoPhase3



Lake Elmo Ave (CSAH 17) - Phase 3

From 30th Street N. to 10th Street N. (Co Rd 10)

COMMENTS & FEEDBACK



NAME* _____

ADDRESS* _____

PHONE* _____

EMAIL* _____

**Contact information is optional*

No curbing
No sidewalk

Bring speed limit down to 30 MPH

Please leave your feedback in the comment box this evening. Comments may also be directed to Kevin Peterson, Washington County Project Manager, at Kevin.Peterson@co.washington.mn.us or by phone at (651) 430-4330. Your feedback will be shared with project staff and included in the project record. Find more information and sign up for email updates at the project website: www.co.washington.mn.us/LakeElmoPhase3



Lake Elmo Ave (CSAH 17) - Phase 3

From 30th Street N. to 10th Street N. (Co Rd 10)

COMMENTS & FEEDBACK



NAME* _____

ADDRESS* _____

PHONE* _____

EMAIL* _____

**Contact information is optional*

- No sidewalk needed
- NO cutouts for parking
- No curb
- County pay for project
- County pay for ongoing maintenance (snow removal)

Please leave your feedback in the comment box this evening. Comments may also be directed to Kevin Peterson, Washington County Project Manager, at Kevin.Peterson@co.washington.mn.us or by phone at (651) 430-4330. Your feedback will be shared with project staff and included in the project record. Find more information and sign up for email updates at the project website: www.co.washington.mn.us/LakeElmoPhase3



Lake Elmo Ave (CSAH 17) - Phase 3

From 30th Street N. to 10th Street N. (Co Rd 10)

COMMENTS & FEEDBACK



NAME* _____

ADDRESS* _____

PHONE* _____

EMAIL* _____

**Contact information is optional*

No Side walks or curb's Please !!
 Speed is a issue & this will not help
 cars speed all the time & what was done
 in the town of Lake Elmo, don't like, getting
 to the Post office, bad deal!
 Const. No more!

Please leave your feedback in the comment box this evening. Comments may also be directed to Kevin Peterson, Washington County Project Manager, at Kevin.Peterson@co.washington.mn.us or by phone at (651) 430-4330. Your feedback will be shared with project staff and included in the project record. Find more information and sign up for email updates at the project website: www.co.washington.mn.us/LakeElmoPhase3



Lake Elmo Ave (CSAH 17) - Phase 3

From 30th Street N. to 10th Street N. (Co Rd 10)

COMMENTS & FEEDBACK



NAME* _____

ADDRESS _____

PHONE* _____

EMAIL* _____

**Contact information is optional*

No side walk in front of our house!
 We would have No front yard left.

Please leave your feedback in the comment box this evening. Comments may also be directed to Kevin Peterson, Washington County Project Manager, at Kevin.Peterson@co.washington.mn.us or by phone at (651) 430-4330. Your feedback will be shared with project staff and included in the project record. Find more information and sign up for email updates at the project website: www.co.washington.mn.us/LakeElmoPhase3



Lake Elmo Ave (CSAH 17) - Phase 3

From 30th Street N. to 10th Street N. (Co Rd 10)

COMMENTS & FEEDBACK



NAME* _____

ADDRESS* _____

PHONE* _____

EMAIL* _____

**Contact information is optional*

We do not want a sidewalk in front of our house. It will ruin our property!
We will end up with no front yard!
People looking right into our house.

Please leave your feedback in the comment box this evening. Comments may also be directed to Kevin Peterson, Washington County Project Manager, at Kevin.Peterson@co.washington.mn.us or by phone at (651) 430-4330. Your feedback will be shared with project staff and included in the project record. Find more information and sign up for email updates at the project website: www.co.washington.mn.us/LakeElmoPhase3



Lake Elmo Ave (CSAH 17) - Phase 3

From 30th Street N. to 10th Street N. (Co Rd 10)

COMMENTS & FEEDBACK



NAME* _____

ADDRESS* _____

PHONE* _____

EMAIL* _____

**Contact information is optional*

NO CURBS AND GUTTERS.

Please leave your feedback in the comment box this evening. Comments may also be directed to Kevin Peterson, Washington County Project Manager, at Kevin.Peterson@co.washington.mn.us or by phone at (651) 430-4330. Your feedback will be shared with project staff and included in the project record. Find more information and sign up for email updates at the project website: www.co.washington.mn.us/LakeElmoPhase3



Lake Elmo Ave (CSAH 17) - Phase 3

From 30th Street N. to 10th Street N. (Co Rd 10)

COMMENTS & FEEDBACK



NAME* _____

ADDRESS* _____

PHONE* _____

EMAIL* _____

**Contact information is optional*

Not interested in a sidewalk

would like to see the speed limit lower

possibly limited hours parking on one side of the road

Please leave your feedback in the comment box this evening. Comments may also be directed to Kevin Peterson, Washington County Project Manager, at Kevin.Peterson@co.washington.mn.us or by phone at (651) 430-4330. Your feedback will be shared with project staff and included in the project record. Find more information and sign up for email updates at the project website: www.co.washington.mn.us/LakeElmoPhase3



Lake Elmo Ave (CSAH 17) - Phase 3

From 30th Street N. to 10th Street N. (Co Rd 10)

COMMENTS & FEEDBACK



NAME* _____

ADDRESS* _____

PHONE* _____

EMAIL* _____

*Contact information is optional

LAKE ELMO AVE FROM 10th ST. TO DOWNTOWN LAKE ELMO
 SHOULD HAVE A SPEED LIMIT OF 30 mph. Why
 would we create a thoroughfare next to the
 lake and into the quaint town of Lake Elmo.
 If you want to move traffic do it on Manning.
 Connect Manning. It is irresponsible to believe you

Please leave your feedback in the comment box this evening. Comments may also be directed to Kevin Peterson, Washington County Project Manager, at Kevin.Peterson@co.washington.mn.us or by phone at (651) 430-4330. Your feedback will be shared with project staff and included in the project record. Find more information and sign up for email updates at the project website: www.co.washington.mn.us/LakeElmoPhase3

Postage
Required

be improving safety by constructing a
wider faster road. The speed limit from
10th St at 55mph **Washington**
County is absurd right now.

Attn: Kevin Peterson, PE
Washington County Public Works
11660 Myeron Road North
Stillwater, MN 55082

To say that the speed limit is not our issue, it
is MNDOT, is a cop out. To even think about
proceeding you need to cut a deal with MNDOT
regarding the speed limit to provide "safety".



FW: Requesting Response: Neighborhood Meeting for Lake Elmo Ave - Phase 3 project

Kevin Peterson

to:

'Kristin Petersen'

06/27/2017 12:04 PM

Cc:

Sue Mason

Hide Details

From: Kevin Peterson <Kevin.Peterson@co.washington.mn.us>

To: 'Kristin Petersen' <kpetersen@sehinc.com>

Cc: Sue Mason <smason@sehinc.com>

[Lake Elmo Phase 3 Comment.](#)

Kevin Peterson | Engineer II

Office: 651-430-4330 | Mobile: 651-347-4330 | Fax: 651-430-4350

Kevin.Peterson@co.washington.mn.us

Washington County Public Works Department

11660 Myeron Rd North | Stillwater, MN 55082

"Plan, build and maintain a better Washington County"



Subject: Re: Requesting Response: Neighborhood Meeting for Lake Elmo Ave - Phase 3 project

Hi Kevin,

Thanks for responding to my email and the information provided. I do not support any off road trail or sidewalk for the project from 30th street to I94. I like it in the old village area but do not support one beyond that at this time.

Will you or when will you have materials that capture the affected properties' responses to your questions? I will stay tuned to the link you provided and hope that the overall input received would also be available following each neighborhood meeting.

Warmly,



From: Kevin Peterson <Kevin.Peterson@co.washington.mn.us>

Sent: Tuesday, June 27, 2017 7:50 AM

Subject: RE: Requesting Response: Neighborhood Meeting for Lake Elmo Ave - Phase 3 project

Good morning [REDACTED],

The scope of the Phase 3 project is to replace the pavement from the south limits of the current construction to I-94. Due to drainage concerns, and to improve safety we intend to install curb and gutter on both sides of the road from the current construction to 20th Street, then replace the pavement south of 20th.

One question we are hoping to answer before beginning construction is if the neighborhood has any interest in an off road trail or sidewalk, so if you have an opinion on that either way please share that with me either at the meeting or via email. This new sidewalk would likely impact your yard, but would not require removal of the new curb and gutter.

We will be posting the meeting materials on the project website (<https://www.co.washington.mn.us/2645/31326/Lake-Elmo-Avenue-Phase-3?activeLiveTab=widgets>), and also have a general public open house scheduled for July 18 (4-6pm at the Church) that will likely present similar materials.

Lake Elmo Avenue (Phase 3) | Washington County, MN ...

www.co.washington.mn.us

Lake Elmo Avenue (Phase 3) Notify Me

The County does not charge residents for their work, but the City may pass costs on through assessments.

I hope that helps, thank you for your questions.

Kevin Peterson | Engineer II

Office: 651-430-4330 | Mobile: 651-347-4330 | Fax: 651-430-4350

Kevin.Peterson@co.washington.mn.us

Washington County Public Works Department

11660 Myeron Rd North | Stillwater, MN 55082

"Plan, build and maintain a better Washington County"



From: [REDACTED]

Sent: Tuesday, June 27, 2017 7:31 AM

To: Kevin Peterson <Kevin.Peterson@co.washington.mn.us>

Cc: [REDACTED]

Subject: Requesting Response: Neighborhood Meeting for Lake Elmo Ave - Phase 3 project

Hi Kevin,

I am sure you are extremely busy getting ready for tonight's neighborhood meeting. I am trying to identify if I should be at this meeting, as I have another meeting conflict at the same time, but want to make sure that I attend his meeting if I will be impacted right in front of my home or will be accessed any fees for the proposed project. Since we were a part of the sewer hook up already we did pay for street reconstruction as part of the fees. Will this project have an impact on me financially and will this proposed project tear up the work that has already been completed in front of my home?

[REDACTED]

From: [REDACTED]

June 26, 2017 7:24 AM

To: kevin.peterson@co.washington.mn.us

Subject: Neighborhood Meeting for Lake Elmo Ave - Phase 3 project

Hi Kevin,

We live at [REDACTED] Lake Elmo Avenue North in Lake Elmo and we have been a part of the old village sewer project that we petitioned to be included. Lake Elmo Avenue in front of our house already has curb and gutters and is just about ready to receive the final layer of asphalt. Can you tell me if the neighborhood meeting scheduled for Tuesday, June 27 regarding phase 3 pertains to my property as well or does it primarily pertain to the properties south of our home that have not had any improvements to date?

Warmly,

[REDACTED]

[REDACTED]



Fw: Comment & Feedback Lake Elmo Ave (CSHA 17)

[Redacted]

to:

kpetersen@sehinc.com

06/28/2017 11:05 AM

Hide Details

From: [Redacted]

To: "kpetersen@sehinc.com" <kpetersen@sehinc.com>

Please respond to [Redacted]

Re-sending due to typo in earlier email address.

----- Forwarded Message -----

From: [Redacted]

To: Kevin Peterson <kevin.peterson@co.washington.mn.us>

Cc: Mindy Leadholm <mindy.leadholm@co.washington.mn.us>; "kpetersowen@sehinc.com" <kpetersowen@sehinc.com>

Sent: Wednesday, June 28, 2017 11:02 AM

Subject: Comment & Feedback Lake Elmo Ave (CSHA 17)

Dear Mr. Peterson,

Thank you for holding the public meeting regarding the proposed options for the project.

I had planned to view the options again (online) prior to sending these comments but do not yet see the materials up yet (Mindy had stated they might be posted today).

Here are my preliminary comments:

1) This stretch is used extensively by bicyclists, both individuals and clubs and races. Hence, **maintaining lane width, and particularly wide shoulders should be a priority for safety.**

2) The stretch is used for walking, but perhaps less so than for bicyclists. Pedestrians and their pet companions walk this stretch year round and have always been served well by the wide shoulders along this stretch. Their safety would not be enhanced by a sidewalk unless there was a commitment from the City of Lake Elmo that they would pass the funding and/or ordinances, and enforce, such that such sidewalks remain cleared year round. I don't believe the City can be relied on to make this happen (as they don't do so currently, even in areas where sidewalks and residential trails have existed for sometime), and hence people will be forced back on the street, now perhaps with narrower lanes and shoulders, for much of the year, decreasing their safety. Hence, **I oppose the installation of a sidewalk on this stretch.**

3) **On-street parking must continue to be allowed along this stretch.** One of the consultants (Sue/Susan) stated that, at least under one or more of the options, there would be no parking allowed on either side of the street. People with lake homes tend to attract large gatherings of friends and family to their homes on summer weekends, and, year round, even for modest-sized gatherings/parties, home driveways cannot accommodate all the parking that might be needed. Moreover, given the parking conditions/prospects on 20th, 24th and 30th, it would be inappropriate to push overflow parking to those locations, nor have people walk the up to half a mile or so back to the home on Lake Elmo Ave they are visiting.

4) Regarding the choice between curb/gutters and ditches, I need to review the plans more closely, and will do so when the info becomes available online.

Thank you for your consideration of my feedback comments.

Kind regards,

Lake Elmo Ave N

**CITY OF LAKE ELMO
WASHINGTON COUNTY
STATE OF MINNESOTA
RESOLUTION NO. 2015-13**

A RESOLUTION ENDORSING "BEE-SAFE" POLICIES AND PROCEDURES

WHEREAS, the City of Lake Elmo Park Commission is dedicated to the protection of pollinators and to promoting a healthy natural environment through the reduction and elimination of harmful pesticides; and

WHEREAS, bees and other pollinators are integral to a wide diversity of essential foods including fruit, nuts, and vegetables; and

WHEREAS, native bees and honey bees are threatened due to habitat loss, pesticide use, pathogens and parasites; and

WHEREAS, recent research suggests that there is a link between pesticides that contain neonicotinoids and the die-off of plant pollinators, including honey bees, native bees, butterflies, moths, and other insects; and

WHEREAS, neonicotinoids are synthetic chemical insecticides that are similar in structure and action to nicotine, a naturally occurring plant compound; and

WHEREAS, the City Council finds it is in the public interest and consistent with adopted City policy for the City to demonstrate its commitment to a safe and healthy community environment through the implementation of pest management practices in the maintenance of the city parks, open spaces and city property.

THEREFORE, BE IT RESOLVED THAT by the City Council of the City of Lake Elmo:

1. The City shall undertake its best efforts to become a Bee-Safe City by undertaking the best management practices in the use of plantings and pesticides in all public places within the City.
2. The City shall refrain from the use of systemic pesticides and systemic insecticides on City owned property including pesticides from the neonicotinoid family.
3. The City shall undertake its best efforts to plant flowers favorable to bees and other pollinators in the City's public spaces.
4. The City shall designate Bee-Safe areas in which future City plantings are free from systemic pesticides including neonicotinoids.
5. The City shall undertake its best efforts to communicate to Lake Elmo residents the importance of creating and maintaining a pollinator-friendly habitat.
6. The City shall publish a Bee-Safe City Progress Report on an annual basis.

NOW, THEREFORE, BE IT RESOLVED THAT the City Council does hereby approve the Bee-Safe Ordinance for the City of Lake Elmo.

Passed and duly adopted this 3rd day of March, 2015 by the City Council of the City of Lake Elmo, Minnesota.

Mike Pearson, Mayor

ATTEST:

Adam Bell, City Clerk

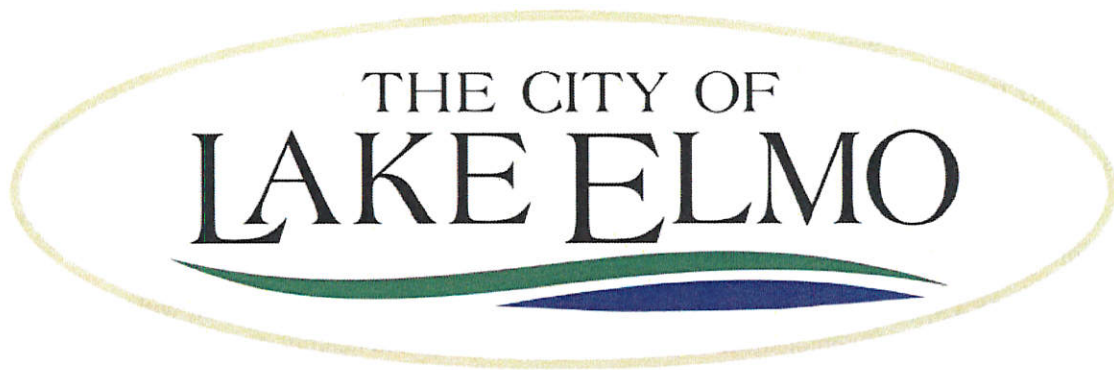

Integrated Pest Management Plan

Table of Contents

Introduction	3
IPM Coordinator	3
Pest Definition	3
IPM Decision Making Strategy	3
Control Methods	5
Pesticide Application and Training	6
Plant-specific Strategies for Minnesota noxious weeds	6
1. Eradicate List	6
2. Controlled List	7
3. Restricted List	7
4. Specifically regulated Plant List	8
Pest Specific Strategies for Site Types	9
Parking Lot and Pavement Preservation	9
Trail Maintenance	11
ROW Maintenance	11
Alternative Pesticide List	12
Insecticide List	14

Introduction

As of March 3, 2015 the City of Lake Elmo has been declared a Bee-Safe City. The use of any pesticide that adversely affects pollinators is prohibited in any of the city's land including parks, roadways, and facility grounds.

Integrated Pest Management (IPM) is a system that establishes a sustainable approach to managing pests by combining cultural, mechanical, physical, biological and chemical tools to eliminate or mitigate economic, environmental and health damage caused by pests. IPM minimizes the use of pesticides and the risk to human health and the environment associated with pesticide applications. This system uses integrated methods, site or pest inspections, pest population monitoring, evaluations of the need for pest control, plus one or more pest control methods such as sanitation, structural repairs, both mechanical and living biological controls, and many other non-chemical methods. If nontoxic options are deemed unreasonable and have been exhausted, then resort to the least toxic pesticides.

The objective of this IPM plan is to:

- Identify cultural, mechanical, physical, biological and chemical control methods to manage noxious plants and pests.
- Identify cultural, mechanical, physical, biological and chemical control methods for maintenance practices including: parking lot and pavement preservation, trail maintenance, ROW maintenance and ecological restoration practices.

IPM Coordinator

The IPM Coordinators are the Planning Director for new developments and the Public Works Director for existing city facilities. The IPM Coordinators are responsible to implement the IPM plan and to coordinate pest management-related communications. The IPM Coordinators will review annually and update the IPM program.

Pest Definition

The primary focus of the IPM is an integrated approach for managing pests. For our purposes, a pest is an organism considered injurious or unwanted by humans. This can include, but not limited to groups, including animals, plants, fungi, and viruses.

IPM Decision Making Strategy

An Integrated Pest Management decision shall consist of the following steps:

1. Identify noxious plant/pest species
2. Monitor and assess the action levels of pests
3. Select the appropriate management methods based on current on-site information

4. Record keeping
5. Assess effectiveness of pest management
6. Tactics for future prevention
7. Further evaluation

1. Identify noxious plant/pest species

Proper and accurate ID of pests is essential for choosing the appropriate control method.

2. Monitor and assess action levels of pests

Some pests and plants can be tolerated at low levels. Monitoring on a regular basis ensures staff is taking action when an action threshold has been reached.

3. Select the appropriate management methods based on current on-site information

Decisions concerning whether or not pesticides should be applied in a given situation will be based on a review of all available options. Efforts will be made to avoid the use of pesticides by adequate pest proofing of facilities, beneficial sanitation practices, selection of pest-resistant plant materials, and appropriate horticultural practices.

When it is determined that a pesticide must be used in order to meet pest management objectives, the least-hazardous material will be chosen. The types of control methods are listed in the next section.

No person shall apply, store, or dispose of any pesticide on without being trained with the Public Works Department's Pesticide/Herbicide Safety training.

4. Record keeping

A record keeping system is essential to establish trends, patterns, and thresholds in pest outbreaks. Information recorded at every inspection or treatment should include pest identification, population size, distribution, recommendations for future prevention, and complete information on the treatment action. Records will be maintained for two years.

5. Assess effectiveness of pest management

Using the records kept by Park staff, and recent monitoring feedback, the IPM coordinator will review the management method used and decide if the method is producing the wanted outcome. If not, the IPM coordinator and staff will develop a new strategy to combat the pest at hand. Only after all IPM methods are expelled will the use of pesticide be necessary.

6. Tactics for future prevention

Prevention is the primary means of this, and any IPM program. Weed and pest problems can be largely avoided by careful design, soil preparation, proper planting/irrigation, and mulching practices. Park staff will use preventative actions to reduce conditions that attract pests to both the facility grounds and buildings. Finalized preventative measures will be incorporated into future and existing structures and designs.

7. Further evaluation

The Environmental Committee will review the IPM program annually to gauge the effectiveness and efficiency of the program. Updates and renovations will be added to the preceding year's IPM.

Control Methods

Once the decision making strategies have been considered and a pest has reached an action threshold, below are types of control methods to consider. These control methods are listed in order of most desirable #1 cultural control, to least desirable #5 chemical control.

1. Cultural control:

- Selecting resistant species
- Proper planting and watering techniques
- Ensure healthy soil by using organic soil amendments such as compost
- Habitat modification

2. Mechanical control:

- Mowing, cutting and pruning
- Mulching
- Hand pulling
- Hand torches/Flamers
- Sanitation practices

3. Physical control:

- Over-seeding
- Thinning plant canopy
- Tree tubes for young trees

4. Biological control:

- Enhancement of favorable environment for natural enemies of pests
- Introduction of native predators
- Use of natural grazers such as goats, sheep, cattle and bison

5. Chemical control:

- Only after exhausting non-chemical control methods
- IPM coordinator must approve and decide on the least toxic chemical to be used

Pesticide Application and Training

The Public Works Director shall be responsible for distributing a pesticide application training document and record keeping documents for staff using pesticides on public

property. Applicators must have the appropriate Minnesota Department of Agriculture pesticide license.

Plant-specific strategies for Minnesota noxious weeds

Minnesota State Statute 18.75 provides a list of plant species that required to be controlled due to their aggressive nature, and potential to cause economic damage to landowners. The City of Lake Elmo uses this list to prioritize control efforts throughout the parks. A description of each species and control methods are described below.

1. Eradicate List

Prohibited noxious weeds that are listed to be eradicated are plants that are not currently known to be present in Minnesota or are not widely established. These species must be eradicated, meaning all of the above and below ground parts of the plant must be destroyed, as required by Minnesota Statutes, Section 18.78. Additionally, no transportation, propagation, or sale of these plants is allowed. Measures must also be taken to prevent and exclude these species from being introduced into Minnesota.

- a. Common teasel (*Dipsacus fullonum*)
- b. Cut-leaved teasel (*Dipsacus laciniatus*)
- c. Dalmatian toadflax (*Linaria dalmatica*)
- d. Giant hogweed (*Heracleum Mantegazzianum* Sommier and Levier)
- e. Grecian foxglove (*Digitalis lanata*)
- f. Japanese hops (*Humulus japonicas* Siebold and Zucc.)
- g. Oriental bittersweet (*Celastrus orbiculatus*)

Mechanical Control:

Small infestations can be hand-pulled, but the entire plant and roots should be removed.

Biological Control:

Goats can be used to suppress re-growth of plants which have been cut.

Chemical Control:

Foliar treatment of Bittersweet can be done with a 2% solution of triclopyr amine (Garlon 3a) mixed in water with a non-ionic surfactant (.5%) to the leaves. (8 oz per 3 gal. mix).

Cut –stem treatment can be done with a 25% mix of triclopyr amine (Garlon 3a) and applied to the stem.

- h. Yellow starthistle (*Centurea solstitialis*)

2. Controlled List:

Prohibited noxious weeds listed to be controlled are plants established throughout Minnesota or regions of the state. Species on this list must be controlled, meaning efforts must be made to prevent the spread, maturation and dispersal of any propagating parts, thereby reducing established populations and preventing reproduction and spread as required by Minnesota Statutes, Section 18.78. Additionally, transportation, propagation, or sale of these plants is prohibited.

- a. Common Barberry, *Berberis vulgaris* L.
- b. Narrowleaf Bittercress, *Cardamine impatiens* L.
- c. Plumeless Thistle, *Carduus acanthoides* (L.)
- d. Spotted Knapweed, *Centaurea stoebe* spp. *micranthos*
- e. Canada Thistle, *Cirsium arvense* (L.) Scop.
- f. Leafy Spurge, *Euphorbia esula* (L.)
- g. Purple Loosestrife, *Lythrum salicaria*, *virgatum* (L.)
- h. Wild Parsnip, *Pastinaca sativa* L. (Except for non-wild cultivated varieties)
- i. Common Tansy, *Tanacetum vulgare* (L.)

3. Restricted List:

Restricted noxious weeds are plants that are widely distributed in Minnesota and are detrimental to human or animal health, the environment, public roads, crops, livestock or other property, but whose only feasible means of control is to prevent their spread by prohibiting the importation, sale, and transportation of their propagating parts in the state except as allowed by Minnesota Statutes, Section 18.82. Plants designated as Restricted Noxious Weeds may be reclassified if effective means of control are developed.

- a. Tree of Heaven, *Ailanthus altissima* (Mill.) Swingle
- b. Garlic Mustard, *Alliaria petiolata* (Bieb.)
- c. Porcelain Berry, *Ampelopsis brevipedunculata* (Maxim.) Trautv.
- d. Crown Vetch, *Securigera varia* (L.) Lassen - formerly *Coronilla varia* L.
- e. Wild Carrot / Queen Anne's Lace, *Daucus carota* L.
- f. Glossy Buckthorn (and all cultivars), *Frangula alnus* Mill. (*columnaris*, *tallcole*, *asplenifolia* and all other cultivars)
- g. Amur Honeysuckle, *Lonicera maackii* (Rupr.) Herder
- h. Morrow's Honeysuckle, *Lonicera morrowii* A. Gray
- i. Bell's Honeysuckle, *Lonicera x bella* Zabel
- j. Common Reed - non-native subspecies, *Phragmites australis* subspecies *australis* (Cav.) Trin. ex Steud.
- k. Common or European Buckthorn, *Rhamnus cathartica* (L.)
- l. Black Locust, *Robinia pseudoacacia* L.
- m. Multiflora Rose, *Rosa multiflora* Thunb.
- n. Tatarian Honeysuckle, *Lonicera tatarica* L.

* For photos of noxious weeds visit:

<https://www.mda.state.mn.us/plants/pestmanagement/weedcontrol/noxiouslist.aspx>

4. Specially Regulated Plant List:

Specially regulated plants are plants that may be native species or have demonstrated economic value, but also have the potential to cause harm in non-controlled environments. Plants designated as specially regulated have been determined to pose ecological, economical, or human or animal health concerns. Plant specific management plans and or rules that define the use and management requirements for these plants will be developed by the Minnesota Department of Agriculture for each plant designated as specially regulated. Measures must also be taken to minimize the potential for harm caused by these plants.

- a. Poison Ivy, *Toxicodendron radicans* (L.) Kuntze & *T. radicans* (Small) Green
Must be eradicated or controlled for public safety along rights-of-ways, trails, public accesses, business properties open to the public or on parts of lands where public access for business or commerce is granted. Must also be eradicated or controlled along property borders when requested by adjoining landowners.
- b. Japanese Knotweed, *Polygonum cuspidatum* Seib. & Zucc. *Synonym as Fallopia japonica* (Houttuyn) Ronse-Decraene
- c. Giant Knotweed, *Polygonum sachalinense* F. Schmidt ex Maxim. *Synonym: Fallopia sachalinensis* (F. Schmidt) Ronse-Decraene
Any person, corporation, business or other retail entity distributing Japanese and/or giant knotweeds for sale within the state, must have information directly affixed to the plant or container packaging that it is being sold with, indicating that it is inadvisable to plant this species within 100 feet of a water body or its designated flood plain as defined by Minnesota Statute 103F.111, Subdivision 4.
- d. Japanese Barberry, *Berberis thunbergii* DC. Phase-out of seediest varieties listed below: These cultivars average greater than 600 seeds per plant and will begin a three-year phase-out period in Minnesota beginning January 1, 2015.
'Anderson' (Lustre Green™); 'Angel Wings'; 'Antares'; 'Bailgreen' (Jade Carousel®); 'Bailone' (Ruby Carousel®); 'Bailsel' (Golden Carousel® - *B. koreana* × *B. thunbergii* hybrid); 'Bailtwo' (Burgundy Carousel®); *B. thunbergii* var. *atropurpurea*; 'Crimson Velvet'; 'Erecta'; 'Gold Ring'; 'Inermis'; 'JN Redleaf' (Ruby Jewel™); 'JN Variegated' (Stardust™); 'Kelleris'; 'Kobold'; 'Marshall Upright'; 'Monomb' (Cherry Bomb™); 'Painter's Palette'; 'Pow Wow'; 'Red Rocket'; 'Rose Glow'; 'Silver Mile'; 'Sparkle'; 'Tara' (Emerald Carousel® - *B. koreana* × *B. thunbergii* hybrid); Wild Type (parent species – green barberry)
At the end of the phase-out period (December 31, 2017), these species will become Restricted Noxious Weeds in Minnesota and will be illegal to sell and propagate.
- e. Amur Maple, *Acer ginnala* Maxim
Sellers shall affix a label that advises buyers to only plant Amur maple and its cultivars in landscapes where the seedlings will be controlled by mowing or other means. Amur maple should be planted at least 100 yards from natural areas.

Pest-Specific Strategies for Site Types

Sites types differ throughout the city and therefore require various control methods to suit their specific needs. Listed below are the site types.

1. Trails and Pathways
2. Waterways
3. Right-of-Ways
4. Landscape Beds
5. Turf Areas
6. Hard Surface Areas
7. Playgrounds
8. Natural Areas
9. No pesticide Zones

Parking lot and pavement preservation

Flame technology

Flame technology for home gardens have been around since the 1940s, and can be used on parking lot and pavement preservations to suppress vegetation growth within the cracks. Portable gas torches that produce heat above 2,000°F and can harm the vegetation structure within seconds. As the flame comes into contact with the vegetation, the heat boils the water within the plants' cells, causing the cells to burst and destroying the cell and foliage. Portable torches should be used in early spring and summer as the annual and perennial weed emerges. Controlling the vegetation at an early stage will save on time and fuel.

Proper personal protective equipment should always be worn and the manufacturer's instructions should be well understood. Torches should never be used during extreme dry periods and the area should be clear of any unwanted debris. Torches should only be used with wind speeds below 5-miles-per-hour and outside of vehicles including Kubota™, Gator™, etc. Torch control works best when the vegetation is one to two inches tall.

Warning signs should be placed at least 100 feet away from the beginning and end of the area of flame work. Flame tanks can range from 14-16oz tanks to five gallon tanks; using a larger tank does increase the time and area that can be burned. While pavement and parking lot protocols are being conducted a fire extinguisher should be within the vicinity in case the fire gets out of comfort. The operator should be wearing fire resistant gloves, long sleeve cotton shirt, long pants, and closed-toes boots. The tank hoses will vary by model. If the tank hose has a "torch bell" a hand lighter with a long neck should be used to light the torch. Do not use matches or a small lighter. Hands should not go near the end of the hose during the ignition process. Review all safety data sheets and company product protocols before going out into the field.

Safety and Protocols

Propane tanks can range from 14-16oz to five gallons using a larger tank increases the time and area that can be burned. While pavement and parking lot protocols are being conducted, a fire extinguisher should be within the vicinity in case the fire gets out of control. The operator should be wearing fire resistant gloves, long sleeve cotton shirt, long pants, and closed-toes boots. The tank hoses will vary by model. If the tank hose has a "torch bell" a hand lighter with a long neck should be used to light the torch. Hands should not go near the end of the hose during the ignition process.

Organic herbicide

SummerSet Alldown Concentrate is a non-selective broadcast leaf and grass herbicide with the primary active ingredients of acetic acid and citric acid. Mixing should be done away from human and vehicle traffic. Alldown should be mixed two part of chemical to one part water (2:1 ratio). Rubber gloves, protective glasses, and long sleeves should be worn while the chemical is being handled.

Pour the designated amount of chemical into the backpack sprayer, use water from the nearest hose to fill the tanks to the desired amount. The hose should NOT be placed in the tank to fill. The hose mouth should be held six to twelve inches away from the sprayer. Spraying should only occur when the temperature is between 65°F - 90°F for effective vegetation degradation. Spraying should be conducted with a wind speed of less than 10 miles-per-hour. Material safety data sheets should be reviewed before using the chemical.

Proper safety equipment should be worn while cleaning; i.e. safety glasses, gloves, long sleeves, and long pants. Rinsing the spraying containers, wands and nozzles should be done away from vehicle traffic, human traffic, and natural water sources. Fill the container ¼ full with water and replace cap to prime pressure. Spray diluted chemical into ground for ten seconds. All containers should be properly labelled.

Chemical Herbicide

Rodeo herbicide can be used to eradicate a broad range of invasive and native vegetation. Rodeo can be mixed in variety sizes of herbicide backpack sprayers and tank sprayers with the correct ration of Rodeo to water. It is necessary to record the; date, applicator, chemical used, location; and if there was an excess amount remaining in the backpack, if a label was created for the backpack, or the backpack was rinsed three times at the end of the use in the Pesticide Application Records three ringed-binder located in the chemical room of its designated park. Spraying should be conducted with a wind speed of less than 10 miles-per-hour and should be conducted between 65°F - 90°F. Material safety data sheets should be reviewed before using the chemical

The chemical and water should be mixed away from human and vehicle traffic. Rubber gloves, protective glasses, and long sleeves should be worn while the chemical is being handled. Pour the designated amount of chemical into the backpack sprayer, use water

from the nearest hose to fill the tanks to the desired amount. The hose should NOT be placed in the tank to fill. The hose mouth should be held six to twelve inches away from the sprayer.

Rinsing the spraying containers, wands and nozzles should be done away from vehicle traffic, human traffic, and natural water sources. Fill the container ¼ full with water and replace cap to prime pressure. Spray diluted chemical into ground for ten seconds. Dispose of excess chemical and refill and repeat actions two more times creating a, “triple rinse”. All containers should be properly labelled as “clean”. If the chemical was not used or cleaned and is still in the container, a label should be placed on top of the container that has the date, chemical, and percent of chemicals (i.e. mmdd rodeo @5%).

Trail maintenance

Management of trails in regards to IPM primarily involves the removal of invasive species, unwanted native species, pesky insects, problematic small mammals, and to ensure the structural integrity of the trail itself. Park staff identify the plant in question and then assess the population at hand. Once an IPM method has been decided on and implicated, further monitoring must be done to ensure the pest is under control or eradicated.

Removal of either invasive or unwanted native species can be done by hand pulling or by using machinery. To prevent vegetative pests on trails, the depth of the trail material is monitored. Thinning trails receive new surface material to combat weed penetration. Insects and small mammal pests are deterred by introducing natural predators or the pest’s natural enemies; this can be done by shaping the infected area to the wanted animal’s preferred habitat. Eroding trails receive new surface material and may need plant species with extensive root systems planted along them to prevent future deterioration.

ROW maintenance

Lake Elmo’s Ordinance for the Management of Right of Ways states: “To provide for the health, safety, and well-being of its citizens, and to ensure the structural integrity of its streets and the appropriate use of the rights-of-way, the city strives to keep its rights-of-way in a state of good repair and free from unnecessary encumbrances.”

Right of ways (ROW) include medians, curbsides, ditches, and landscape beds within the right of way. Since the City of Lake Elmo is a Bee-Safe City, the goal of the ROW maintenance is to provide suitable habitat for pollinators, with special emphasis on bees and monarch butterflies. This includes planting native plants in diverse and dense amounts, reducing mowing, and limiting herbicide use.

Alternative Pesticide List – 2017

PESTICIDE OR BEST PRACTICE	USED FOR
Phydura – Organic (Soil Tech Corp) citric acid, malic acid, clove oil	HERBICIDE: non-selective herbicide for herbaceous broadleaf and grass weeds including garlic mustard and leafy spurge.
Scythe – Organic (DOW AgroSciences) Perlargonic acid	HERBICIDE: removes or burns waxy cuticle of green vegetation. Will not translocate. Non-selective, post-emergence for grasses and broadleaf weeds, perennial herbaceous plants. Alternative to glyphosate.
White Vinegar or acetic acid (Final Stop by Dr. Earth)	HERBICIDE: Broad spectrum for weeds and grasses including poison ivy. Apply during hot sunny months.
AllDown – Organic (Summerset)	HERBICIDE: Non-selective annual broadleaf, perennial weeds and grass herbicide including Canada Thistle. Acetic acid, citric acid. Will not translocate. Alternative to glyphosate.
Burn-out / Bonide – Organic (Bayer CropScience) clove oils, citric acid	HERBICIDE: post defoliant on annual, perennial and grassy weeds. Non selective. Will kill most roots, will not translocate. Alternative to glyphosate.
Corn gluten – Organic	HERBICIDE: pre-emergent herbicide for germinating weed seeds for broadleaf and grassy weeds. Often used for landscapes and gardens.
Integrated Pest Management Practices	Monitoring, identification and long term planning for insects and plants. Ground covers, biological controls, hedgerows, beetle banks, wind blocks, and hand pulling weeds. Improving soil health. Carefully planned mowing, brush hogging and management.
Fire: Flameweeding, blow torch, controlled burns	Used for weeds in crevices, along roadsides, trails. Annual controlled burns to encourage diversity and soil health.
Plant Identification charts and education: for example: Thistle (Natives: Hills, Tall, Field, Flodmans, Swamp) (Non-native: Canada, Bull, Plumeless, Musk)	Field staff may mistake native thistle for non-native. Visual field charts plus education can cut down on maintenance (State of Ohio uses this practice)
Shade cloth smother	Leave shade cloth in place for 1-2 years, remove and reseed in nutrient rich soil (State of Oregon uses for knapweed control)

Goats or sheep	For large areas that are hard to manage, wooded areas with bushes and invasives like buckthorn. Fencing can be a challenge for goats. (Washington County used for buckthorn)
Soil testing	Make soil inhospitable for undesirable plants by augmenting soil with nutrients contrary to what non native plant requires (such as magnesium)
Surround WP (Novasource) Kaolin clay	INSECTICIDE: for fruit trees, bushes and plants. Sprayed on plants, leaves a protective powdery film on surface of leaves, stems and fruit. Controls long list of insect pests on fruit trees and ornamentals. Avoid spraying on blooming flowers and pollinators. (Used extensively in South America and Africa)
Bacillus Thuringiensis (BT bacteria)	INSECTICIDE: Naturally occurring soil bacterium kills specific insect larvae like cabbage worm larvae. Can be used to target mosquito and black fly larvae.
Beneficial Insects (like hover flies, braconid wasps, tachinid flies, lacewings, lady beetles)	When scouting plants for pests, check for both pest and beneficial insects such as lady beetles and bees. If beneficial insects are present, wait to treat and see if the beneficial insects can control the pest insects.
Roadside mowing practices	Reduce mowing of roadside beyond clear zone to benefit pollinators and reduce maintenance costs. Reduce frequency of mowing (one side per year), or timing (October or later). Restore remnant habitat and existing native vegetation.
Protect pollinators. Use pesticides only when absolutely necessary. Least toxic insecticides include: boric acid, diatomaceous earth, neem oil, horticulture soap, and kaolin clay.	If pesticides are necessary, use spot treatments. Do not use systemic insecticides which are highly toxic to pollinators and stay in the plant, soil or tree. Never spray flowers or buds. Do not apply while plants are in full bloom. Spray in the evening when bees are not foraging.
Swarm Catchers: 651-436-7915	Statewide swarm rescue. Identify the insect species first if possible. Catchers will rescue and relocate honeybees, bumblebees and some native bees.
<i>Resources: Compiled by Pollinatorfriendly.org 1/2017</i>	www.omri.org (Organic Materials Review Institute) www.beyondpesticides.org (Pesticide Gateway found under Resources) www.pesticideinfo.org (PAN Pesticide Database) www.cdms.net/label-database (Data Logic Database)

Insecticide Toxicity to Bees: By Active Ingredient

Chemical class	Examples of common names	Examples of trade names	Toxicity			
			Non	Low	Mod	High
Carbamates	carbaryl	Sevin				x
Neonicotinoids	Imidacloprid (I) thiamethoxam (T) clothianidin (C) dinotefuran (D) imid+bifenthrin (I,B)	Nursery/landscape Merit, Marathon, Flagship, Meridian, Arena, Aloft, Safari, Allectus, Field crops: Gaucho (I), Poncho (C), Cruiser(T) (seed treatments), Admire/Provado (I), Venom (C), Platinum (T)				x
	Acetamiprid (A), thiacloprid (T)	Tristar (A), Assail (A), Calypso (T)		x		
Organophosphates	acephate, chlorpyrifos, dimethoate, malathion, phosmet	Orthene, Dursban/Lorsban, Dimethoate, Malathion, Imidan				x
Pyrethroids	bifenthrin, cyfluthrin, fenpropathrin, lambda- cyhalothrin, permethrin	Attain/Talstar, Tempo, Decathalon, Tame, Scimitar, Astro				x
Botanical	pyrethrum/pyrethrins azadirachtin, neem oil	Pyganic, Azatin, Ornazin, Triact				x
Insect growth regulators	diflubenzuron tebufenozide	Adept, Dimilin, Confirm			x	
	azadirachtin buprofezin pyriproxyfen	Aza-Direct, Azatin, Ornazin, Talus Distance		x		
	novaluron	Pedestal				x
Juvenile hormone	s-kinoprene	Enstar II		x		
Diamides	chlolantraniliprole	Acelepryn	x			
Macrocyclic lactones	abamectin/ivermectin, emamectin benzoate	Avid, Tree-Age				x
Miticides	acequinocyl, extoxazole, fenpyroximate, fenbutatin-oxide	Shuttle, TetraSan, Akari, Vendex	x			
	clofentezine, hexythiazox	Ovation, Hexagon		x		
	bifenazate	Floramite			x	
	pyridaben	Sanmite				x
Spinosyns	spinosad	Conserve/Entrust, less toxic dried		x		
Tetronic acids	spiromesifen	Judo			x	
Tetramic acid deriv	spirotetramat	Kontos				x
GABA-gated chloride channel	fipronil	Fipronil, Termidor,				x
Pyridine carboxamide	flonicamid	Aria	x			
Pyridine azomethines	pymetrozine	Endeavor	x			
Other insecticides	<i>Bacillus thuringiensis</i> , <i>Cydia pomonella granulovirus</i>	Bt/Dipel, Carpovirusine/Cyd-X	x			
	Kaolin clay, soaps	Surround, M-Pede		x		
	horticultural mineral oils	Monterey Oil			x	
	indoxacarb	Provaunt				x

- For a list of bee safe herbicides visit:
http://www.medinabeekeepers.com/index.php?title=Pesticide_toxicity
- Plants and Grasses: <http://cues.cfans.umn.edu/old/gervais/keytable.htm>
- Additional resources: https://www.pesticideresearch.com/site/?page_id=9990
http://pollinatorstewardship.org/?page_id=1994



STAFF REPORT

DATE: July 11, 2017

ITEM #: V

DISCUSSION

TO: City Council

FROM: Emily Becker, City Planner

AGENDA ITEM: Amendments to Chapter 72: Parking Regulations and Chapter 73: Parking Schedules of the City Code

REVIEWED BY: Stephen Wensman, Planning Director
Jack Griffin, City Engineer
Greg Malmquist, Fire Chief
Michael Bent, Building Official
Kristina Handt, City Administrator

BACKGROUND:

Chapter 73: Parking Regulations of the City Code currently prohibits parking in certain "No Parking" zones throughout the City, unless a temporary parking permit has been issued by the City Administrator. There are a number of new developments that have streets that do not meet street width standards for parking on both or even one side of the street, according to adopted City Engineering Standards.

ISSUE BEFORE COUNCIL:

The City Council is being asked to consider Ord. 08-XXX which adds streets within new developments that do not meet City Engineering Standards for street width for parking on both or one side of the street.

REVIEW/ANALYSIS:

Adopted City Engineering Standards indicate the following minimum street width for parking:

- Both sides of the street: 28 feet
- One side of the street: 24 feet
- No parking: 22 feet or less

Streets with No or One-Sided Parking Added. As previously stated, there are a number of new developments that have streets that do not meet these standards. These street names need to be added to Schedule I. Parking Prohibited of Chapter 73: Parking Schedules.

Fines Removed. Lastly, fines for parking of trailers was stricken, as the City no longer references administrative citations in the Code. The process outlined in the amended Section 10.99 shall be followed.

FISCAL IMPACT:

Most of the new/proposed No Parking areas are signed properly. The only areas that are not signed (signs are not called for in approved plans) are in Boulder Ponds and Savona along 5th St and Junco Ave in Savona. These areas would require about 17 signs at approx. \$100 each installed by PW Staff.

RECOMMENDATION:

The City Council is being asked to discuss the proposed changes and direct staff whether or not to move this item forward to a future Council Meeting.

ATTACHMENTS:

- Ord. 08-XXX
- No Parking Map

**CITY OF LAKE ELMO
COUNTY OF WASHINGTON
STATE OF MINNESOTA**

ORDINANCE NO. 08-XXX

**AN ORDINANCE AMENDING THE LAKE ELMO CITY CODE OF ORDINANCES BY
ADDING ADDITIONAL STREETS ON WHICH PARKING IS PROHIBITED TO
CHAPTER 73: PARKING SCHEDULES.**

SECTION 1. The City Council of the City of Lake Elmo hereby amends Title VII: Parking Schedules; Chapter 73: Parking Schedules; Schedule I: Parking Prohibited, by adding the following:

 SCHEDULE I. PARKING PROHIBITED.

No vehicle shall be parked in the following "No Parking" zones, unless a temporary parking permit has been issued by the City Administrator as provided in § 72.02.

<i>Street</i>	<i>Location</i>	<i>Sides</i>
—	Two signs added 45 feet apart at the asphalt trail into Carriage Station Park	—
Eagle Point Boulevard	From Inwood Avenue to Hudson Boulevard	Both
15th Street N.	From Ivy Avenue N. to the east end of the street	Both
50th Street	From DeMontreville Trail N. to Hill Trail N. in Lanes DeMontreville Country Club	Both
50th Street	From State Highway 5 to CSAH 17 (Lake Elmo Avenue)	Both
53rd Street N.	DeMontreville Highlands, 5th Addition	Both
Highlands Trail North	From DeMontreville Trail to a distance 100 yards from the intersection with DeMontreville Trail North on both segments of Highlands Trail N. in DeMontreville Highlands	Both
Hill Trail N.	Lanes DeMontreville Country Club	Both
Jamaca Avenue North	475 feet south of its intersection with Lake Jane Trail	Both
Jane Road North	Beginning at the south line of PID 10-029-21-24-0003 extending 33 feet northerly, thereof	West
Klondike Ave. N.	The south 100 feet to the dead end	Both
Lake Jane Trail N.	From 250 feet west of Jamaca Avenue N. to Jane Road N.	Both
Laverne Ave. N.	From Upper 33rd Street to 36th Street and the east side only from 36th Street N. to State Highway 5 <u>and within the Hunter's Crossing Development where medians exist</u>	Both
Layton Avenue N.	From 36th Street N. to State Highway 5	West
32nd Street N.	From Lampert Ave. N. to Klondike Ave. N.	North
<u>Village Pkwy.</u>	<u>All</u>	<u>Both</u>
<u>Entrance to Easton Village</u>	<u>All, ending at intersection of 32nd St N and Linden Ave N</u>	<u>Both</u>
<u>Junco Rd N</u>	<u>Eyebrow</u>	<u>One-Side</u>

		<u>Where Signed</u>
<u>Jay Ave. N</u>	<u>All</u>	<u>Both</u>
<u>5th St Ln N</u>	<u>Where medians exist</u>	<u>Both</u>
<u>Upper 7th St N</u>	<u>All</u>	<u>One-Side Where Signed</u>
<u>Lower 8th Pl N</u>	<u>All</u>	<u>One-Side Where Signed</u>
<u>Irving Blvd N</u>	<u>East side of Island Trail, where median exists</u>	<u>One-Side Where Signed</u>
<u>Irving Cir N</u>	<u>All</u>	<u>One-Side Where Signed</u>
<u>9th Pl N</u>	<u>All</u>	<u>One-Side Where Signed</u>
<u>Upper 9th Pl N</u>	<u>All</u>	<u>One-Side Where Signed</u>
<u>Island Trl N</u>	<u>Where medians exist</u>	<u>Both</u>
<u>Blazing Star Ln</u>	<u>On eyebrows</u>	<u>One-Side Where Signed</u>
<u>Wildflower Dr N</u>	<u>All, except entrance where street width measures 28 feet</u>	<u>Both</u>
<u>Monarch Path N</u>	<u>All</u>	<u>Both</u>
<u>Monarch Way N</u>	<u>All</u>	<u>Both</u>
<u>Monarch Park</u>	<u>All</u>	<u>Both</u>
<u>Hummingbird Path N</u>	<u>All</u>	<u>Both</u>
<u>Sunflower Ln N</u>	<u>All</u>	<u>One-Side Where Signed</u>
<u>Jade Trl N</u>	<u>Where medians exist</u>	<u>Both</u>
<u>Jade Ct N</u>	<u>Where medians exist</u>	<u>Both</u>
<u>8th St N</u>	<u>Eyebrow within Lakeridge Crossing Development</u>	<u>One-Side Where Signed</u>
<u>CSAH 17</u>	<u>44th St N to 50th St N</u>	<u>West Side</u>

 **SCHEDULE II. PARKING OF TRAILERS.**

(A) No trailer shall be parked in the following “No Trailer Parking” zones unless a temporary parking permit has been issued by the City Administrator as provided in § 72.02.

<i>Lake DeMontreville Public Access</i>	
<i>Street</i>	<i>Location</i>
53rd Street	From Demontreville Trail to the west of the street
DeMontreville Trail	From 50th Street to DeMontreville Circle
Highlands Trail	From Hilltop Avenue to DeMontreville Trail; and from DeMontreville Trail to Highland Trail Court
Hytrail	From Highlands Trail to 59th Street

50th Street	From Hilltop Avenue to the east end of the street
<i>Lake Jane Public Access</i>	
Lake Jane Trail	From Irvin Court to Tapestry Drive
Jamaca Avenue	From Lake Jane Trail to 42nd Street
Jane Road	From Lake Jane Trail to Jane Court

~~—(B) Any person who violates the provisions of this schedule shall, upon conviction, be subject to a fine of not less than \$150 nor more than \$300, plus the cost of prosecution.~~

(Ord. 97-179, passed 9-19-2006)

SECTION 2. The City Council of the City of Lake Elmo hereby amends Title VII: Parking Schedules; Chapter 72: Parking Regulations, by amending the following:

§ 72.01 GENERALLY.

(A) *Parking and fire lanes.*

(1) (a) The Council, upon report and recommendation of the Administrator and Fire Chief, may order the establishment of fire lanes on public or private property in order that the travel of fire equipment may not be interfered with and that access to fire hydrants or buildings may not be obstructed. The fire lanes shall be designated by appropriate signs indicating "no parking - fire lane" or words of similar import.

(b) The city shall erect and maintain the signs on public property. The owner of private property shall erect and maintain the signs on owner's property at owner's expense within 30 days after notification of the establishment of a fire lane.

(2) After appropriate signs have been erected, no person shall park a vehicle or otherwise occupy or obstruct a fire lane.

(B) *Parking term.* No person shall park or permit any vehicle to stand upon any highway, street, alley, or any other public property in the city for more than 48 consecutive hours.

(C) *Trailers.* The provisions of this section shall apply to the parking of trailers as well as vehicles.

(1997 Code, § 1005.01) (Am. Ord. 97-179, passed 9-19-2006) [Penalty, see § 10.99](#)

§ 72.02 TEMPORARY PARKING PERMIT.

(A) An owner who resides adjacent to a posted "No Parking" zone may obtain up to 2 temporary parking permits per calendar year for a special non-business or social event (including, but not limited to, weddings, birthday parties, family reunions, bar mitzvahs, confirmations, first communions, fraternal gatherings, holiday gatherings, and the like) by making application to the City Administrator at least 3 working days before the date of special event.

(B) A temporary parking permit shall allow for parking of residential passenger vehicles within a "No Parking" zone for a period not to exceed 24 consecutive hours.

(C) The City Administrator shall notify the County Sheriff before issuing a temporary parking permit and shall arrange to have the posted "No Parking" Signs covered during the period described in the permit.

SECTION 3. Effective Date. This ordinance shall become effective immediately upon adoption and publication in the official newspaper of the City of Lake Elmo.

SECTION 4. Adoption Date. This Ordinance 08-___ was adopted on this _____ day of ___ 2017, by a vote of ___ Ayes and ___ Nays.

LAKE ELMO CITY COUNCIL

Mike Pearson, Mayor

ATTEST:

Julie Johnson, City Clerk

This Ordinance 08-___ was published on the ___ day of _____, 2017.

Streets - No Parking

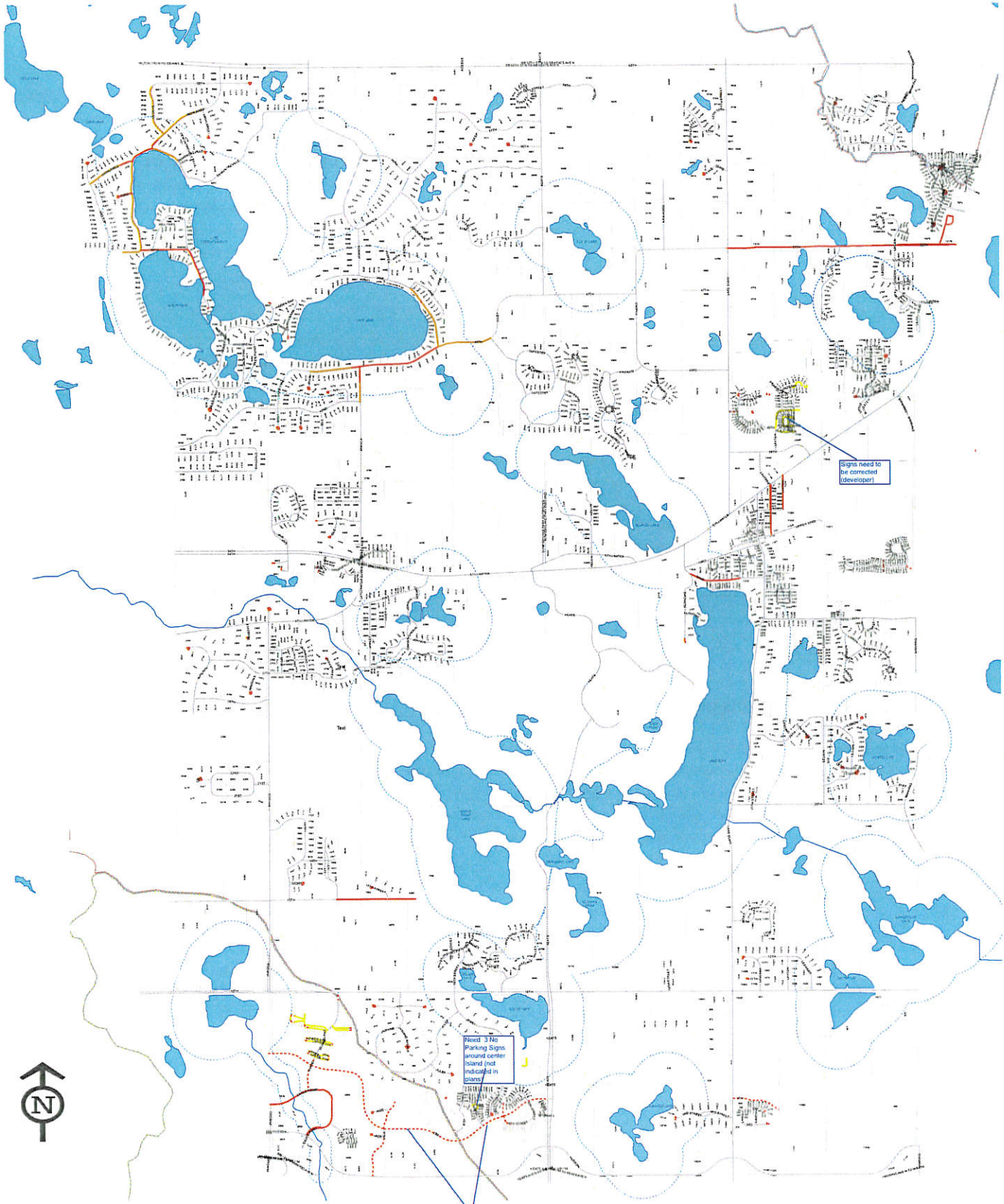

Existing No Parking: ———

Proposed No Parking: - - - - -

Existing No Trailer Parking: ———

Proposed No Parking One Side: ———

STAFF REPORT

DATE: July 11, 2017

DISCUSSION

ITEM #: VI

AGENDA ITEM: InWood Water Tower Logo
TO: Mayor and City Council
SUBMITTED BY: Kristina Handt, City Administrator

BACKGROUND:

Councilmembers Lundgren and Fliflet requested this item be included in the July 11th Workshop Agenda. Attached is the staff report from the March 21, 2017 Council Meeting where this item was discussed and the Council voted 3 – 0 to apply the City logo on the southwest side of the tower. Councilmembers Bloyer and Fliflet were absent from that meeting.

Staff is currently attempting to obtain updated pricing for the addition of a second logo on the tower and we hope to have that information for you at the workshop.

STAFF REPORT

DATE: 3/21/17

REGULAR

ITEM #: 25

MOTION

TO: City Council

FROM: Rob Weldon, Public Works Director

AGENDA ITEM: Inwood Ave. Water Tower Logo Change

REVIEWED BY: Kristina Handt, City Administrator

BACKGROUND: As construction begins to commence for the season and the completion date of the new Inwood Ave. Water Tower draws closer, an opportunity to change the painted logo on the water tower has opened. “Branding”, or including official city logos and slogans is becoming a popular site on water towers across the country and right here in the Twin Cities Metro Area. This new style of logo moves away from traditional “Block” letters that depict a city’s name and provide a more appealing logo that is inviting to visitors and residents alike, while displaying city pride.

ISSUE BEFORE COUNCIL: Should the City Council authorize a change order to apply the city logo on the Inwood Ave. Water Tower?

PROPOSAL DETAILS/ANALYSIS: When construction plans were approved for the Inwood Ave. Water Tower, they were approved in a way that would match the new tower to the existing Tower #2 at the Public Works Facility. Tower #2 was constructed and painted to match the Public Works Facility, white with red block letters spelling out Lake Elmo.

With the location of the new Inwood Tower in more of a residential area, the exterior color scheme that was approved to match Tower #2 is not very conducive to the surroundings of the new water tower. By changing, and

moving away from the red “Lake Elmo” block letters and applying the city logo to the new water tower a more appealing color scheme would be visible to residents and visitors while boasting the official city logo to travelers along the I-94 & I-694 corridors.

Once completed, the selected logo applied to the water tower will be visible for approximately 15-20 years. That is the typical expected life of properly applied paint coatings on water towers.

FISCAL IMPACT: \$10,000 to apply logos to both north and south sides of water tower.

\$ 5,000 (approx.) to apply city logo to southwest side of water tower.

OPTIONS: -Approve change order to apply the city logo on two sides of the Inwood Ave. Water Tower. -Approve change order to apply the city logo on one side of the Inwood Ave. Water Tower.
-Make no changes to the approved water tower plans.

RECOMMENDATION:

Motion to approve a change order authorizing the City of Lake Elmo logo to be applied on the southwest side of the Inwood Ave. Water Tower.

ATTACHMENTS: - City logo
- Tower #2 at Public Works
- CB&I email

LAKE ELMO

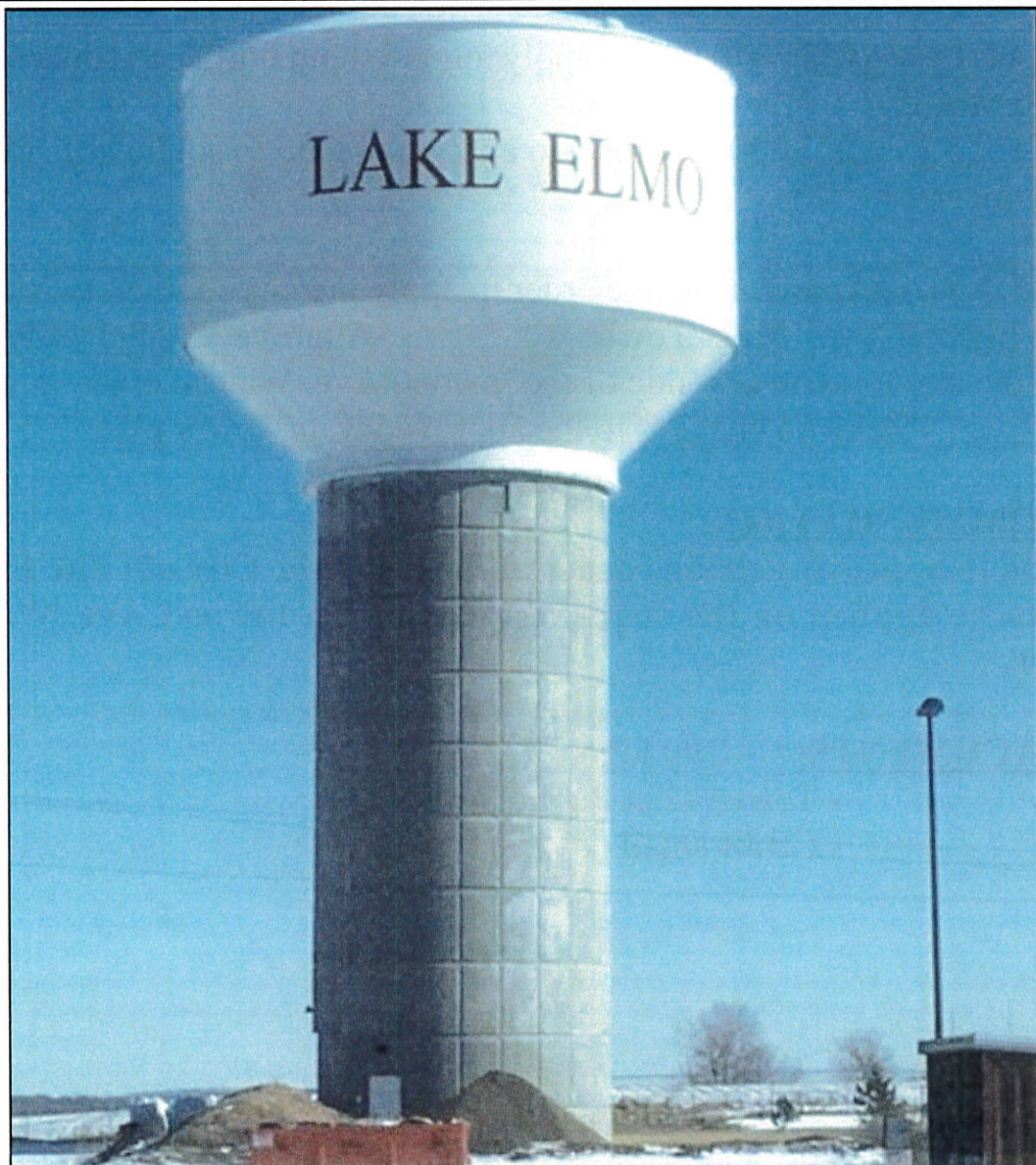

From: "Pegel, Bill" <Bill.Pegel@CBI.com>
To: Chad Katzenberger <ckatzenberger@sehinc.com>
Date: 03/03/2017 09:09 AM
Subject: RE: Inwood water tower logo change price

Chad,

Apologize for the delay in getting a response back to you. The suggestions below would have very little impact in the costs. Main costs in the changes is the manhours to add the accents underneath the letters. Just more time moving the rigging and tracing out the design and also more time rolling the design. The new logo is much more appealing and I hope I can help get it on the tower. I can pull out engineering to change the drawings and also time for estimating and myself to process the changes and just give you a raw price of \$10,000. This would just simply be the adder for additional paint colors, labor to layout/execute and little adder for more intricate template. Let me know if this helps and what the City would like to do. Thanks.



Bill Pegel
Project Manager
Central Operations
Fabrication Services
Steel Plate Structures
Tel: +1 815 439 6537
Cell: +1 815 210 1676
Fax: +1 815 439 3130
Bill.Pegel@CBI.com
CB&I
14109 S. Route 59
Plainfield, IL 60544-8984
United States
www.CBI.com





POLLINATOR FRIENDLY ALLIANCE
WWW.POLLINATORFRIENDLY.ORG
651-503-9904

7-11-17
File Copy

INTEGRATED PEST MANAGEMENT, LAKE ELMO INTRODUCTION

Introduction to Integrated Pest Management, City of Lake Elmo.

As recommended by Pollinator Friendly Alliance, U of M Center for Urban Ecology & Sustainability, Washington County and the State of Minnesota.

WHY INTEGRATED PEST MANAGEMENT

- Suburban, urban, turf and park areas are especially well suited for IPM programs.
- IPM and pollinator protection practices foster community pride and increase property values.
- People prefer to live in areas that protect wildlife, clean water and environment.
- Community leaders make decisions that directly affect the health and well-being of the people, environment and water in their communities. Citizens rely on leaders to make good decisions and implement best practices.
- Reduced labor and chemical costs. A landscape managed through sustainable methods requires low inputs of labor, fertilizers, herbicides, insecticides, and fungicides, while supporting beneficial insects, pollinators and wildlife. Excessive use of these chemicals pollutes surface and ground water, disturbs natural ecosystem processes, and harms precious pollinators.

WHAT IS INTEGRATED PEST MANAGEMENT (IPM) (see attached samples)

A sound, sensible approach to dealing with pests – insects, plant diseases, noxious weeds and more— with methods that protect human health and the environment while saving money. IPM is integrated because it brings together a range of biological, organic, cultural, mechanical, and chemical options. A well-defined IPM should be based on long term prevention strategies, monitoring, and control.

RECOMMENDATIONS CITY OF LAKE ELMO

- Implement IPM Program to include turf conversion to low mow or prairie.
- Reduce or eliminate turf herbicide treatments replace with IPM best practices.
- Develop retro-fit management program for land management (refer to Audubon Certified Sustainability Program, Xerces Society, BWSR, or U of M).
- Conduct inventory of herbicides, fungicides, insecticides used on city property including subcontractors. Eliminate systemic insecticides especially neonicotinoids and fipronil. Educate management supervisors and operators on pesticide toxicity and use, noxious weed identification, and IPM management practices.

WHY PROTECT POLLINATORS:

- Pollinators are crucial to our world's survival. Pollinators form the base of the food chain that wildlife and humans depend upon. 85% of Minnesota food crops need insect pollination.
- Pollinators are in crisis. More than half of North America's wild bees are in decline and 1 in 4 are at risk of extinction. Beekeepers lose 40-50% of their hives.
- 2017 Minnesota statewide poll shows 87% of Minnesotans are concerned about pollinator declines. 2016 Minnesota Executive Order directs all state agencies to implement pollinator protection programs and removes neonic pesticides from public lands.
- Over 30 communities and counties have implemented protection resolutions, with more to come.

St. Paul neighbors, B&Bs seek to regulate short-term rentals

BY JANE McCLURE

The days of unregulated vacation and Airbnb-type rental units may be nearing an end in St. Paul. The city's Planning Commission held a public hearing on June 2 on a proposed package of zoning, licensing and taxing requirements for short-term rentals. More than two dozen people turned out for the hearing, and the general sentiment appeared to be that some type of regulation is warranted.

Short-term rentals such as Airbnb and Vacation Rental By Owner (VRBO) provide inexpensive lodging options for travelers as well as extra income for the owners of homes, condominiums and apartment buildings. However, they can disrupt neighborhoods accustomed to the high turnover of transients. They also compete for business with hotels and bed-and-breakfast establishments that are licensed and regulated and pay sales and lodging taxes. Another concern is the ability of private investors to buy apartment build-

ings and turn them into unregulated hotels. The St. Paul City Council requested city staff to research and draft regulations for short-term rentals last year due to neighborhood complaints and the concerns of the hospitality industry. The Twin Cities has experienced a boom in rental housing over the past decade, and city officials are hoping to get the new regulations in place before the horde of visitors arrive next February for Super Bowl LII at U.S. Bank Stadium.

The study by the city's departments of Planning and Economic Development and Safety and Inspections drew on the experiences of other cities that regulate short-term rentals. St. Paul has about 250 short-term rentals, although that number fluctuates and can be difficult to estimate.

The new regulations would affect the individual hosts of short-term rentals as well as the online platforms that book the rentals, such as VRBO and Airbnb. The intent is to make short-term rentals legal entities with a clearly defined set of standards, including off-street parking requirements, a prohibition on signage in residential areas, and a ban on large social and commercial events, according to city planner Kady Dadlez.

Single-family homes and duplexes would be limited to one short-term rental per city lot, or

1 ◀ DFL ENDORSING CONVENTION

residents Catherine Hunt and Howard Miller said they hope he stays in the race. Goldstein "has a great mind and comes up with the most practical solutions, like broadband for the whole city," Miller said.

"He's the clearest and most concise candidate who offers the same straightforward positions in public and private," Hunt said. "He's committed to transparency and accountability, things we're not seeing in the Ford site

planning process."

Harris delegate Peggy Summers of Highland Park was not worried when her candidate was dropped from the fifth ballot because she knew he was moving on to the general election. "I've known (Harris) for most of his life," she said. "He has a proven record of success in getting things done. He was responsive to constituents as a City Council member, and he'll be the same as mayor."

Former St. Paul Mayor George Latimer said he thought Harris' decision to stay in the race

two short-term rentals in an owner-occupied duplex, unless they obtained a conditional use permit. In other zoning districts, the number of short-term rentals would be limited to half of the units in a building, up to a maximum of four, without a conditional use permit.

Short-term rentals should be regulated in the same way as bed-and-breakfasts, hotels and motels, according to Kris Ullmer, executive director of the Professional Association of Innkeeper International.

Lance Bondhus of the Minnesota Vacation Rental Alliance said his group generally supports the regulations. However, he added, the short-term rental industry does regulate itself. Patrons are encouraged to rate their hosts, he said, "and if you're a bad host, you don't get people staying again."

Several individual hosts of short-term rentals told the Planning Commission that they should be allowed to operate without excessive licensing and parking requirements. They spoke of the benefit of short-term rentals for themselves as well as their guests.

Summit Hill resident Stacy Johnson rents out two units in her triplex to short-term guests and lives in the third unit. The majority of her guests are senior citizens who fly in for family functions and want to stay in a historic neighborhood, she said. They usually do not

with or without the endorsement "was the right decision. While the conventions are important, they represent too small of a sample of voters throughout the city," Latimer said. "This is more about the election than it is the party endorsement in a DFL-dominated town with ranked choice voting, so let the people decide in the general election."

Receiving the DFL endorsement for the three open seats on the St. Paul School Board were incumbents Jeanelle Foster and John Brodrick and newcomer Manav Viana. A

have cars.

"If I rented my triplex to conventional, long-term residents, there could be six cars on the street," she said. "Typically now there are only two cars on any given day."

Ramsey Hill resident Anastasia Galati said she has rented rooms to more than 150 short-term guests in the past three years. The income from those rentals has allowed her to maintain her home and continue to live there.

"The regulations the city is proposing sound reasonable, but they could be abused," said Pam Biladeau, who owns and operates a bed-and-breakfast in Ramsey Hill. According to her, she and her partner, Cory Biladeau, had to meet many requirements before opening their B&B. Meanwhile, a short-term rental near the University of St. Thomas houses up to 12 people with little regulation.

The B&B owners questioned the city's ability to assess sales and lodging taxes on the approximately 15 short-term rental platforms. B&Bs are subject to state inspections for food service and lodging, and the owners questioned how the city would find, let alone inspect, the hundreds of short-term rentals.

The package of proposed regulations will return to the Planning Commission later this month for a recommendation before they are forwarded to the City Council.

fourth DFL candidate, Eduardo Barrera, bowed out of the race and promised to work for the DFL ticket in November.

The formal candidate filing period for mayor and School Board will be held from August 1-15. With ranked-choice voting in the mayoral election, there will be no September primary. Expected to be joining the four DFLers on the mayoral ballot in the November 7 general election are Green Party candidate Elizabeth Dickinson and independent candidate Tim Holden.



**Lake Elmo Ave (CSAH 17) Corridor Management
and Safety Improvement Project
CSAH 10 to 30th Street**

City Council Workshop

July 11, 2017

**Kevin Peterson, PE
Washington County Project Manager**



7-11-17
File Copy



Topics

- Project Overview
- Project Goals
- Project Schedule
- Community Outreach
- Next Steps



CSAH 17 (Lake Elmo Avenue) from 30th Street to CSAH 10 (10th Street)

Two distinct segments:

10th St to 20th Street

Ditch Drainage

45-55 mph Speed Limit

Current ADT 5200 vpd

2040 Project ADT 9100 vpd

20th Street to 30th Street

Ditch Drainage toward lake

Bituminous Curb drainage east

30-45 mph Speed Limit

Current ADT 4350 vpd

2040 Project ADT 7800 vpd

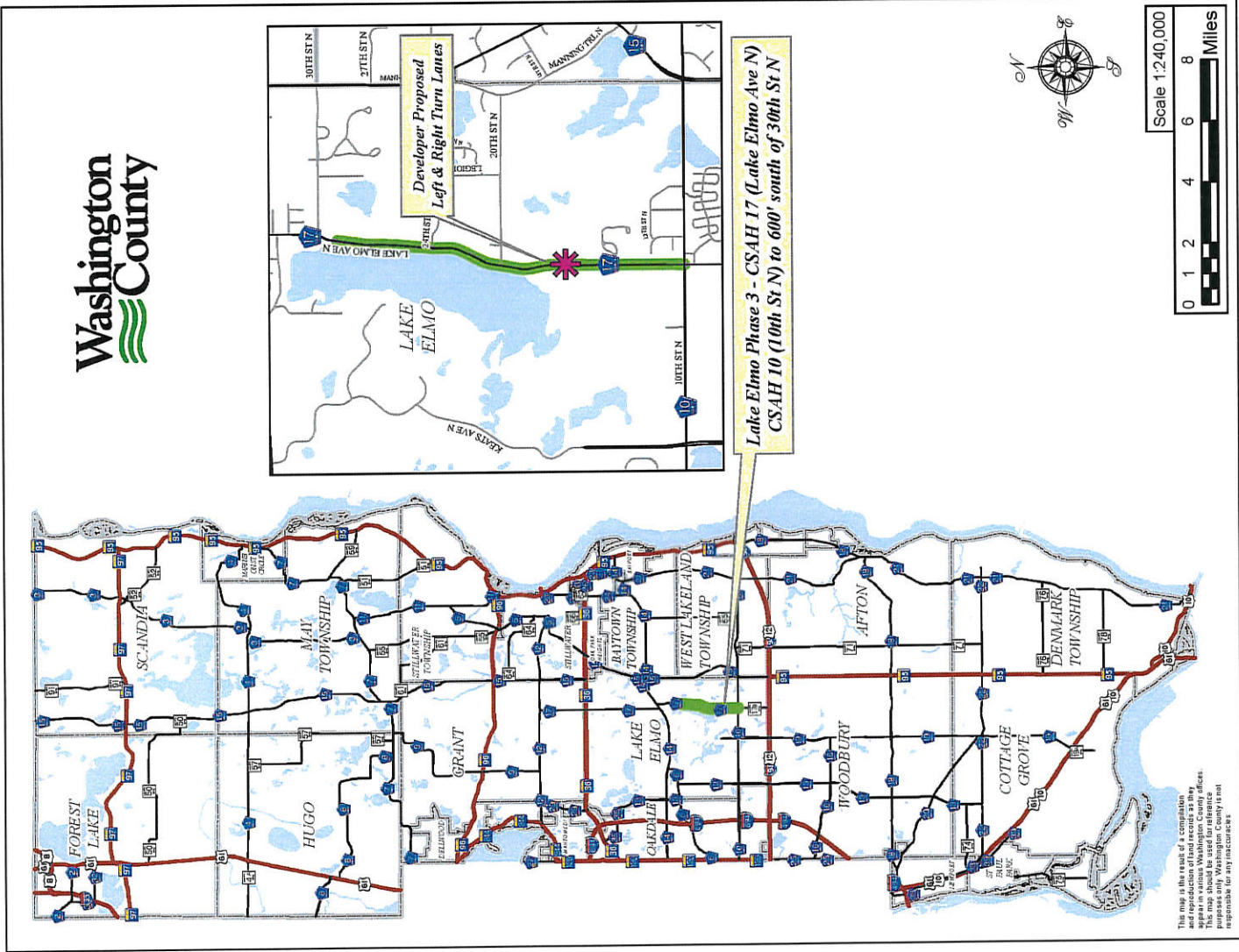

This map is the result of a compilation and reproduction of land records as they appear on the ground. Washington County does not warrant the accuracy of this map. This map should be used for reference purposes only. Washington County is not responsible for any inaccuracies.

Project Goals

- **Improve pavement life**
- **Improve pavement quality/ride**
- **Investigate improvements to stormwater quality and quantity**
- **Evaluate options, and public desire, for off-road pedestrian facilities**

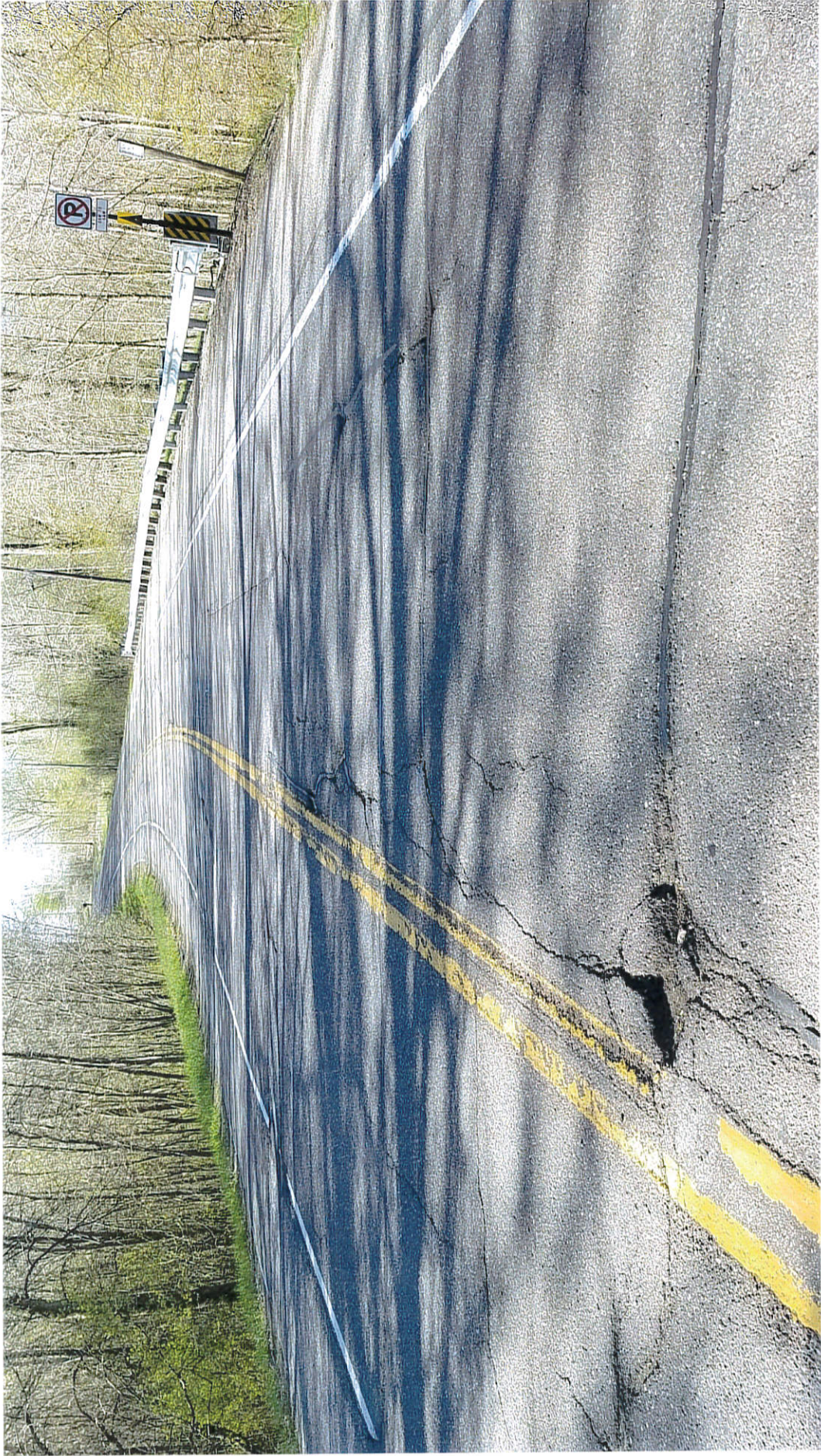





Washington
County

Project Schedule

- June to Oct 2017 – Data Collection
Public Involvement
Environmental
Documentation
Drainage Analysis
Intersection Analysis
Preliminary Design
- October 2017 – Alternative Selected
- Winter 2017 – Final Design
- Spring 2018 – Begin Construction

Project Schedule

	2017												2018										
	J	F	M	A	M	J	J	A	S	O	N	D	J	F	M	A	M	J	J	A			
Project Kick Off							▲																
PMT Meetings						○	○	○	○	○	○	○	○	○	○								
Neighborhood Meeting & Open House						☐ 6/27	☐ 7/18	☐ (To be determined)															
Preliminary Design						-----																	
Municipal Consent									X														
Final Design													-----										
Right-of-way																	----- (if needed)						
Phase 2 Construction (Began Summer 2016)						-----																	
Phase 3 Construction																					-----		

Community Outreach

- **Adjacent Neighbor Meeting**
- **Community Open House**
- **Pre-Construction Community Open House**

Community Outreach Adjacent Neighbor Meeting

- June 27, 2017
- 4pm-6pm, Christ Lutheran Church
- 48 properties invited
- Open House style with boards and maps

Community Outreach Adjacent Neighbor Meeting



Community Outreach

Adjacent Neighbor Meeting

Alternate 1: Proposed Reconstruction with Ditch Drainage

- 2 traffic lanes
- 6 foot dual purpose shoulder
- Shoulder provides room for commuter bicyclists and stalled or turning cars
- Ditch drainage
- Steep slope and clear zone along the lake still challenging
- Eliminates bituminous curb maintenance concern
- Tree and landscaping impacts

Reconstruction with Ditch Drainage

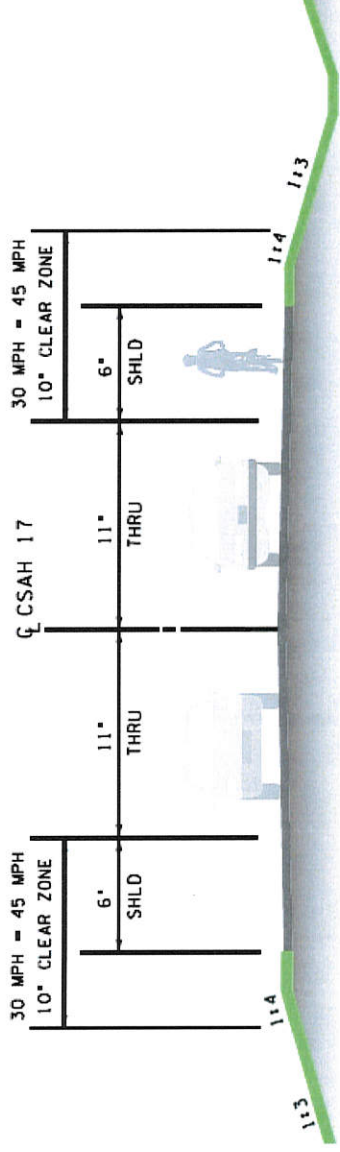

Community Outreach

Adjacent Neighbor Meeting

Alternate 2: Proposed Reconstruction with Curb and Gutter Drainage

- 2 traffic lanes
- 6 foot dual purpose shoulder
- Shoulder provides room for commuter bicyclists and stalled or turning cars
- Curb and gutter drainage allows for smaller clear zone requirement and mitigates steep slope concern
- Eliminates bituminous curb maintenance concern

Reconstruction with Curb and Gutter Drainage

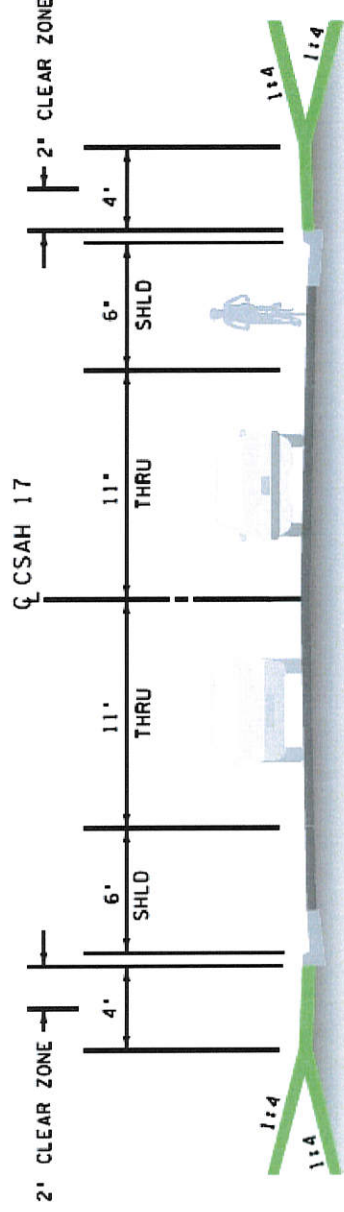

Community Outreach

Adjacent Neighbor Meeting

Alternate 3: Proposed Reconstruction with Curb and Gutter Drainage & Addition of a 5 Foot Wide Sidewalk

- 2 traffic lanes
- 6 foot dual purpose shoulder
- 5 foot walk on east side
- Shoulder provides room for commuter bicyclists and stalled or turning cars
- Curb and gutter drainage allows for smaller clear zone requirement and mitigates steep slope concern
- Eliminates bituminous curb maintenance concern
- Tree and landscaping impacts

Reconstruction with Blvd and Walk Option

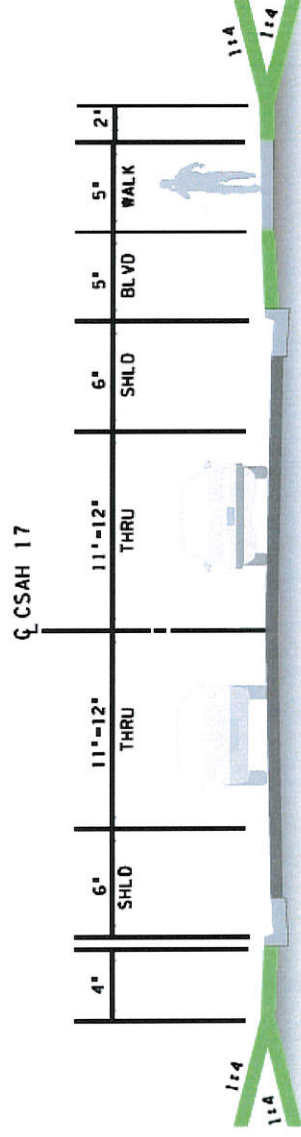

Community Outreach Adjacent Neighbor Meeting

- Approximately 23 attendees
- 20 written comments at meeting
- One verbal comment documented by staff
- Two e-mailed comments
- One mailed comment

Community Outreach

Adjacent Neighbor Meeting

- 11 Comments about speed limit and safety
- 10 comments opposed to sidewalks
- 4 comments about property impacts
- 4 comments about potential assessments
- 3 comments supportive of sidewalks
- Comments to protect existing parking

Community Outreach

- Adjacent Neighbor Meeting
- Community Open House
 - Tuesday July 18, 2017
 - 4pm-6pm
 - Christ Lutheran Church
- Pre-Construction Community Open House
 - TBD

Next Steps

- Determine Preferred Alternative
- Resolution of Support
- Pre-Construction Open House
- Construction



Questions?

