



STAFF REPORT

DATE: February 2, 2021

CONSENT

AGENDA ITEM: Approve Resolution Establishing Municipal State Aid Streets

SUBMITTED BY: Jack Griffin, City Engineer

REVIEWED BY: Kristina Handt, City Administrator
Marty Powers, Public Works Director
Chad Isakson, Assistant City Engineer

ISSUE BEFORE COUNCIL: Should the City Council approve the designation of Lake Jane Trail North/42nd Street North, from Ideal Avenue (CSAH 13) to Jamaca Avenue North, and Julia Avenue North, from Hudson Boulevard to 5th Street North as municipal state aid routes thereby increasing the municipal state aid system by 1.28 miles?

BACKGROUND: As a Municipal State Aid city, the City of Lake Elmo is eligible to designate certain higher volume roadways that are functionally classified as collector or arterial streets, as Municipal State Aid routes, and are eligible to receive a proportionate share of state aid funding to assist with the maintenance and construction of the MSA roadway network. Streets designated as Municipal State Aid Streets must meet the selection criteria of Rule 8820.0700, sub. 3. The City is allowed to designate roadway mileage up to a cap of 20% of the total local and county roadway system within the City limits. In addition, the City is allowed to designate any county road or county state aid highway (CSAH) which is turned back to the city with said mileage being over and above the 20% limitation.

Municipal State Aid (MSA) funding is allocated in accordance with state statutes with one-half of the annual funding based on each city's population relative to other state aid cities, and one-half of the annual funding based on each city's estimated "Needs".

PROPOSAL DETAILS/ANALYSIS: As part of the City's Municipal State Aid System the City must certify to the Office of State Aid the total mileage within the corporate limits of Lake Elmo. Due to the development activities over the past three years, Lake Elmo increased the total mileage of streets by 6.78 miles. The certification of these streets to the office of State Aid in 2019 and 2020 has increased the City's ability to designate an additional 1.56 miles of municipal state Aid streets (20%). Therefore, staff has reviewed the City's Municipal State-Aid road network and is recommending that Lake Jane Trail North/42nd Street North, from Ideal Avenue (CSAH 13) to Jamaca Avenue North, and Julia Avenue North, from Hudson Boulevard to 5th Street North be designated as Municipal State Aid Streets.

FISCAL IMPACT: With the designation of Lake Jane Trail North/42nd Street North, and Julia Avenue North as municipal state aid routes the City will increase the City's state aid system by approximately 1.28 mile of roadway, leaving an additional 0.28 eligible miles undesignated. The additional roadway will increase the City's determination of Needs on an annual basis resulting in an increased allocation of Municipal State Aid funding.

RECOMMENDATION: Staff is recommending that the City Council approve, *as part of the Consent Agenda*, a Resolution approving revision to the City's Municipal State Aid System (MSAS) as presented to designate Lake Jane Trail North/42nd Street North, from Ideal Avenue (CSAH 13) to Jamaca Avenue North, and Julia Avenue North, from Hudson Boulevard to 5th Street North, as municipal state aid routes for the determination of Needs. If removed from the consent agenda, the recommended motion for the action is as follows:

“Move to approve Resolution 2021-016, Establishing Lake Jane Trail North/42nd Street North, and Julia Avenue North, as Municipal State Aid Streets.”

ATTACHMENTS:

1. Resolution Establishing Municipal State Aid Streets.
2. 2020 Certification of Mileage.
3. Lake Jane Trail North/42nd Street North MSA Designation Map.
4. Julia Avenue North MSA Designation Map.

**CITY OF LAKE ELMO
WASHINGTON COUNTY
STATE OF MINNESOTA**

RESOLUTION NO. 2021-016

A RESOLUTION ESTABLISHING MUNICIPAL STATE AID STREETS

WHEREAS, the City of Lake Elmo has reviewed the City's Municipal State Aid Street System and has identified system revisions in accordance with the policies and goals of the City's future growth and development and Comprehensive Transportation Plan; and

WHEREAS, based on these recommendations, it appears to the Lake Elmo City Council that the streets hereinafter described should be designated Municipal State Aid Streets under the provisions of Minnesota Law.

NOW, THEREFORE, BE IT RESOLVED, by the City Council of the City of Lake Elmo that the streets described as follows, to-wit:

STREET NAME	LENGTH	FROM	TO
Lake Jane Trail North	0.63 miles (3,320 ft.)	Ideal Avenue (CSAH 13)	42nd Street North
42nd Street North	0.46 miles (2,430 ft.)	Lake Jane Trail North	Jamaca Avenue North
Julia Avenue North	0.19 miles (1,023 ft.)	Hudson Boulevard	5th Street North

be, and hereby are, established, located, and designated a Municipal State Aid Street of the City of Lake Elmo subject to the approval of the Commissioner of Transportation of the State of Minnesota.

BE IT FURTHER RESOLVED, that the City Clerk is hereby authorized and directed to forward certified copies of this resolution to the Commissioner of Transportation for consideration, and upon approval of the designation of said roads or portion thereof, that same be constructed, improved and maintained as a Municipal State Aid Street of the City of Lake Elmo, and to be numbered and known as a Municipal State Aid Street.

ADOPTED BY THE LAKE ELMO CITY COUNCIL ON THE SECOND DAY OF FEBRUARY, 2021.

CITY OF LAKE ELMO

(Seal)
ATTEST:

By: _____
Charles Cadenhead
Mayor

Julie Johnson
City Clerk

2020 ANNUAL CERTIFICATION OF MILEAGE

SEE INSTRUCTIONS INCLUDED ON WEB SITE
RECORD REVISIONS ON BACK OF FORM
SUBMIT TO YOUR DSAE BY JANUARY 15, 2021

	Municipal Mileage as of Dec. 31, 2019				Revisions During Current Year 2020 (+ or -)				Municipal Mileage as of Dec. 31, 2020			
	Non- Existing	Unimproved	Improved	Total	Non- Existing	Unimproved	Improved	Total	Non- Existing	Unimproved	Improved	Total
	I	II	III	IV	V	VI	VII	VIII	IX	X	XI	XII
MILEAGE NOT CONSIDERED IN THE COMPUTATION OF BASIC MILEAGE												
1. Trunk Highways												
2. Trunk Highways Turnbacks (Designated as MSAS - mileage above 20%)												
3. County State Aid Highways (Exclude mileage designated as MSAS)			23.51	23.51			(0.05)	(0.05)			23.46	23.46
4. County State Aid Highway Turnbacks (Designated as MSAS - mileage above 20%)												
5. Total Mileage of Line 1 Thru 4	Previous =		23.51	(+ or -) Adjustment =		(0.05)	Current =				23.46	
BASIC MILEAGE: MILEAGE CONSIDERED IN THE COMPUTATION OF ALLOWABLE MILEAGE												
6. Municipal State Aid Streets (Exclude Trunk and County Highway Turnbacks and Mileage Partly Outside the City Limits in a non MSAS city)			16.97	16.97							16.97	16.97
7. County Road Turnbacks (Designated as MSAS)			2.15	2.15			0.49	0.49			2.64	2.64
8. County Roads (Exclude mileage designated as MSAS)			1.00	1.00							1.00	1.00
9. Other Local Roads And Streets - not designated (Include T.H. & CSAH frontage roads)			70.95	70.95			1.11	1.11			72.06	72.06
10. Total Improved Basic Mileage (lines 6 + 7 + 8 + 9)	Previous =		91.07	(+ or -) Adjustment =		1.60	Current =				92.67	
11. Percentage Limitation Allowed by Statute											X	0.20
12. MAXIMUM MILEAGE ALLOWED FOR M.S.A.S. DESIGNATIONS (Col XI, Line 10 Times Line 11)												18.53
13. Total Municipal State Aid Street Designated (Column XII, Line 2 + 4 + 6 + 7)											19.61	
14. Total Miles of T.H. & County Turnbacks designated as MSAS Above 20% (Col. XII Line 2 + 4 + 7)											(-) 2.64	
15. Mileage designated MSAS - not including T.H. and County Turnback mileage (Line 13 minus Line 14).											(-) 16.97	
16. MSAS Mileage Partly Outside the City Limits in a non MSAS city (if any)											(-) 1.56	
17. Municipal State Aid Street Mileage Over/Under Maximum Allowed. (Line 12 minus line 15 minus Line 16)												1.56

I hereby certify that the total Improved Mileage (Col. XI, Line 5 + 10) in the Municipality of Lake Elmo as of December 31, 2020 is 115.02 Miles.

Signed John (Jack) W. Griffin, P.E. Title Lake Elmo City Engineer Date 01/06/2021

NOTE: Lines 2, 4, 6, & 7 are MSAS mileage categories

Shaded Fields contain formulas. These fields get filled automatically as data is entered.

Lake Jane Trail N./42nd Street N.

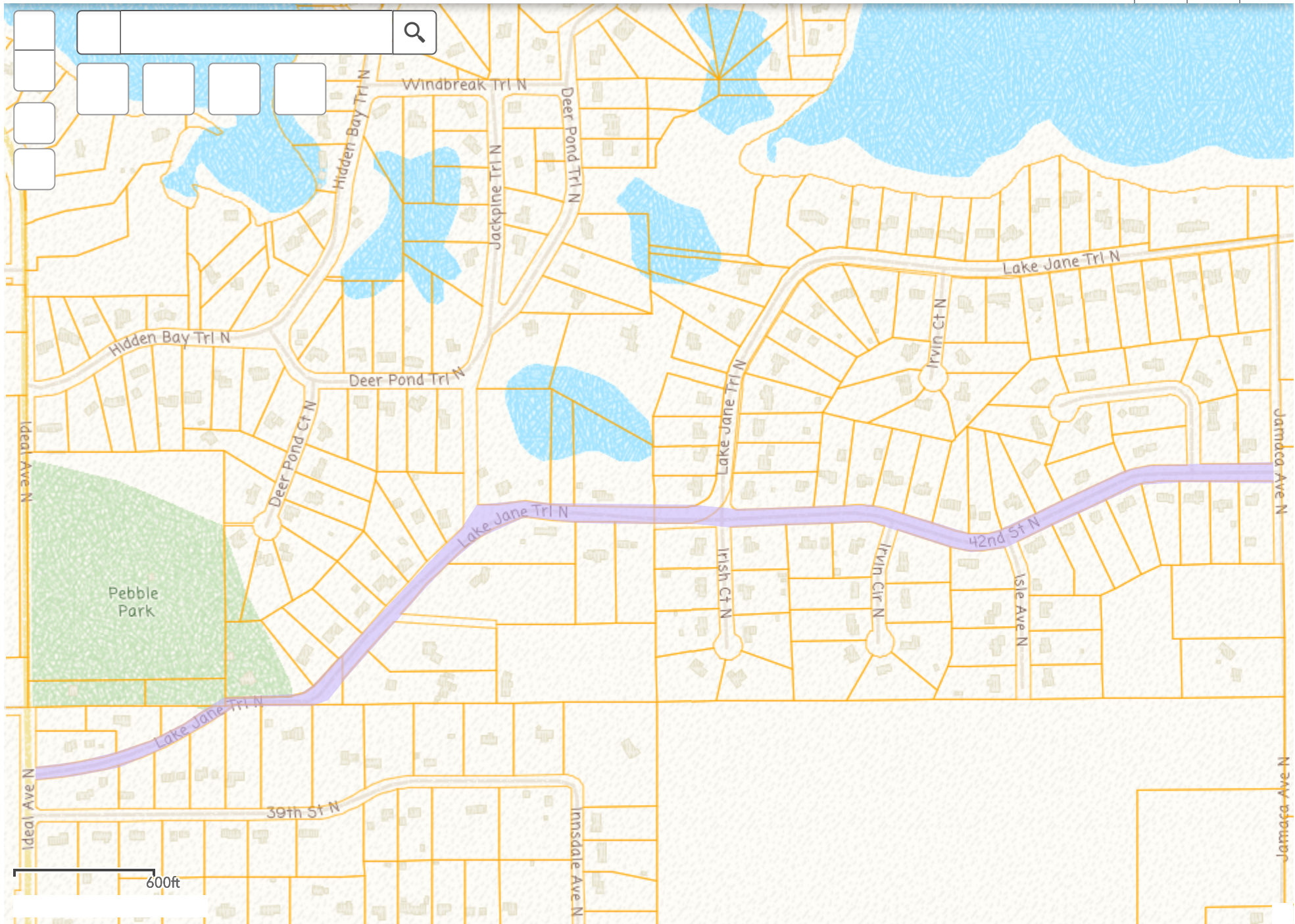

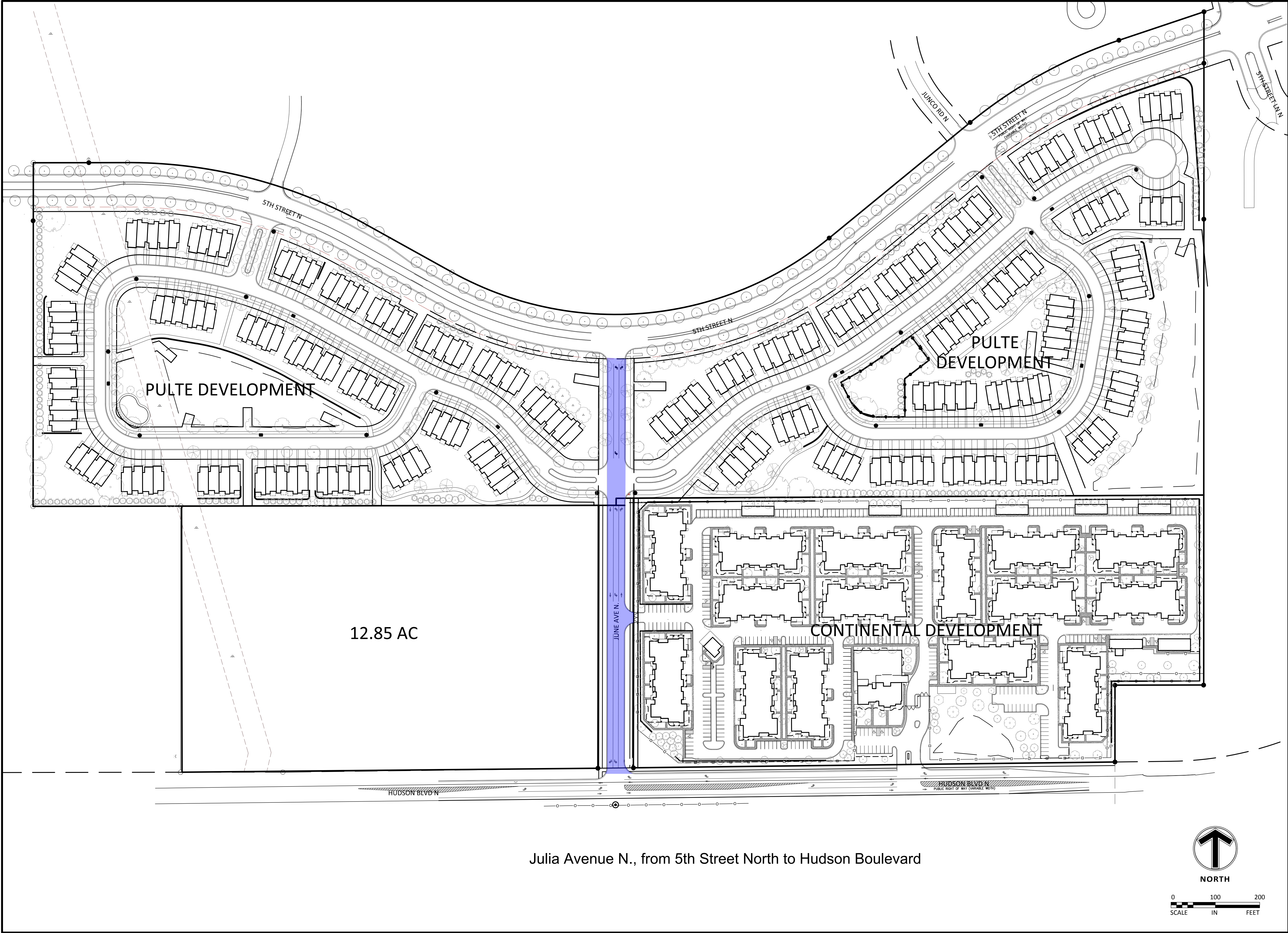

Julia Avenue N., from 5th Street North to Hudson Boulevard

Client
CONTINENTAL
483 FUND LLC

W134 N8675 EXECUTIVE PARKWAY
MENOMONEE FALLS, WI 53051

Project
SPRINGS AT
LAKE ELMO

Location
LAKE ELMO,
MINNESOTA
9955 HUDSON BOULEVARD NORTH

Certification

PRELIMINARY

Summary
Designed: EAV Drawn: CIL
Approved: EAV Book / Page:
Phase: PRELIMINARY Initial Issue: 4/12/2019

Revision History

No.	Date	By	Submittal / Revision
4/12/2019			CITY SUBMITTAL
5/1/2019			CITY PRELIMINARY RESUBMITTAL

Sheet Title
OVERALL
DEVELOPMENT
PLAN

Sheet No. Revision
C2.06

Project No. 21654