

CITY OF LAKE ELMO
WASHINGTON COUNTY
STATE OF MINNESOTA

RESOLUTION NO. 2011-011

A RESOLUTION APPROVING PLANS AND SPECIFICATIONS
AND ORDERING ADVERTISEMENT FOR BIDS FOR THE
LAKE ELMO AVENUE INFRASTRUCTURE
PROJECT I-94 TO 30TH STREET

WHEREAS, pursuant to resolutions passed by the council, TKDA was directed to prepare plans and specifications for the Lake Elmo Avenue Infrastructure Project I-94 to 30th Street;

AND WHEREAS, TKDA has completed the design for an alternate bid to include gravity sewer south of 10th Street;

AND WHEREAS, TKDA has completed the plans and specifications for these improvements and has presented them to the City Council for approval on March 15, 2011;

NOW, THEREFORE, BE IT RESOLVED,

- 1. Such plans and specifications, a copy of which is on file at Lake Elmo City Hall and made a part hereof, are hereby approved.*
- 2. The City Clerk shall prepare and cause to be inserted in the official paper and in the Finance and Commerce an advertisement for bids upon the making of such improvements under such approved plans and specifications. The advertisement shall be published for at least 21 days, shall specify the work to be done, and shall state that sealed bids provided to the City Clerk prior to the specified bid date and time and accompanied by a bid bond or cashier's check made payable to the City of Lake Elmo in an amount not less than 5% of the amount of such bid will be considered.*

Date: March 15, 2011

CITY OF LAKE ELMO

By:

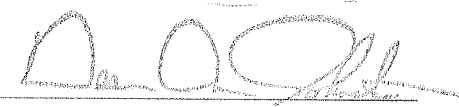
Dean A. Johnston
Mayor

ATTEST:

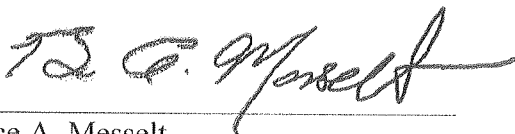

Bruce A. Messelt
City Administrator

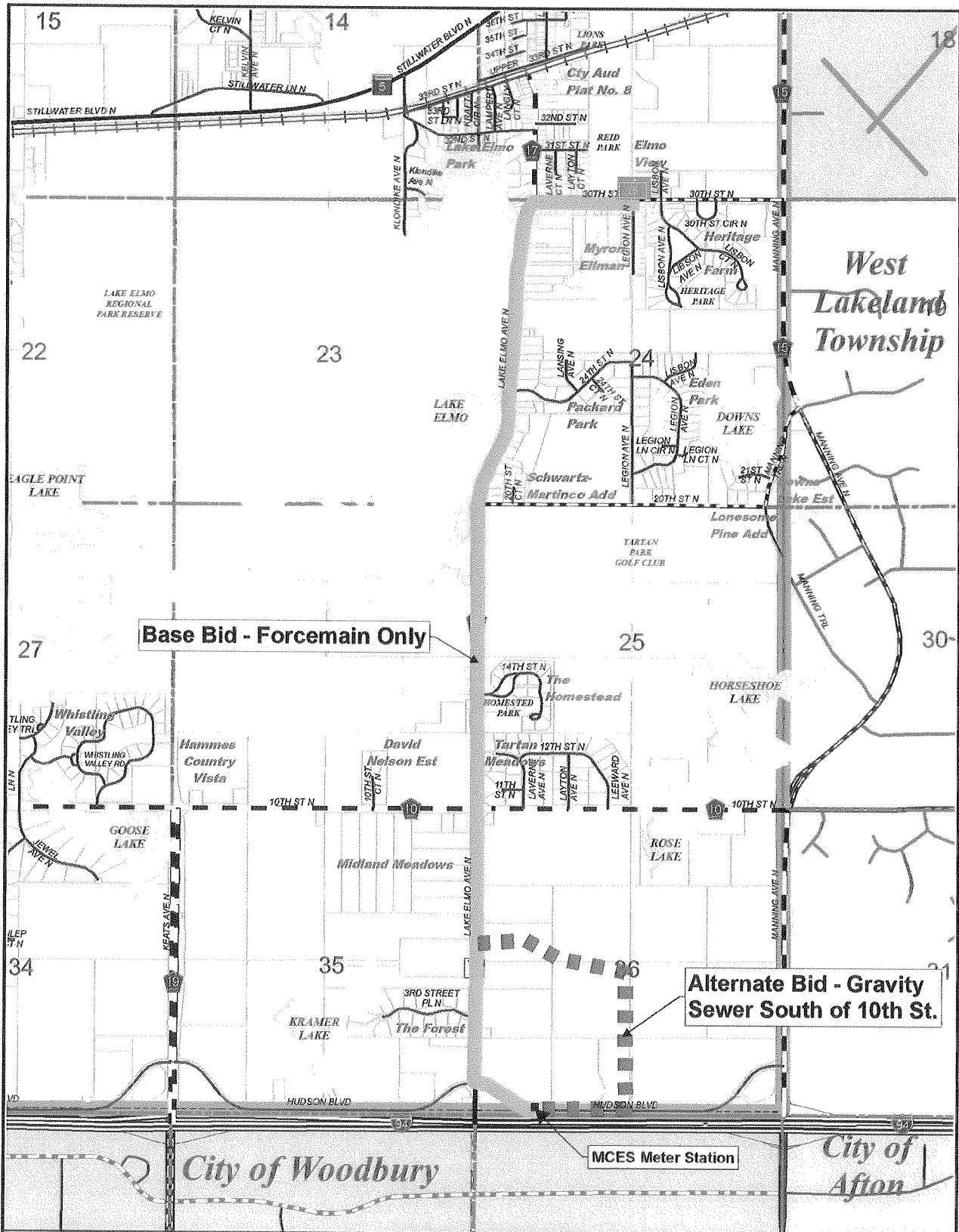

Base Bid - Forcemain Only

Alternate Bid - Gravity Sewer South of 10th St.

MCES Meter Station



LOCATION MAP

Legend

- Base Bid - Forcemain Only
- Alternate Bid - Gravity Sewer South of 10th Street

- City Hall
3505 L. Avenue N
551977-4510
www.lakeelmo.org
- Public Works Building
3445 102nd Ave N
651233-4414
- Fire Stations
Station No. 1
5015 L. Avenue N
651970-5030
Station No. 2
4250 L. Avenue N
651979-8832
- Schools
- Parcels
- Subdivisions
- City Parks
- Golf Course
- Lake Elmo Regional Park Reserve
Park Office
651430-4388
- Lakes

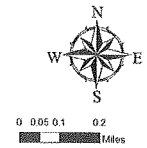

0 0.05 0.1 0.2 Miles

Map Date: March 2011

Created By
TKDA
TERRITORY KREMER DESIGN ARCHITECTS
The Right Team. The Right People. The Right Company.